

# LEAD-BASED PAINT INSPECTION

*for*

**PIKE COUNTY HOUSING AUTHORITY  
PITTSFIELD UNITS  
PITTSFIELD, ILLINOIS**

*date of sampling:*

**MAY 14 & 15, 2013**

*table of contents:*

- ① INTRODUCTION
- ② SUMMARY OF FINDINGS (POSITIVE MATERIALS)
- ③ XRF ANALYSIS SUMMARY
- ④ SITE PLAN(S)
- ⑤ INSPECTOR'S CREDENTIALS  
RADIOACTIVE MATERIAL LICENSE

*consultant:*

**HINDS ENVIRONMENTAL, INC.  
2975 STANTON STREET  
SPRINGFIELD, ILLINOIS 62703  
(217) 585-8970 • FAX (217) 585-8879**

*HINDS PROJECT # 13123*

# **SECTION 1**

## INTRODUCTION

### **A. APPLICABLE STANDARDS**

This inspection report was developed in accordance with HUD/EPA standards for lead-based paint of 1.0 mg/cm<sup>2</sup> or 0.5% by weight as defined by Title X of the 1992 Housing and Community Development Act. Title X is also known as the Residential Lead-based Paint Hazard Reduction Act of 1992.

### **B. PROTOCOL**

#### **INSPECTION PROTOCOL**

The intent of this lead-based paint inspection was to inspect and identify lead-based paint on building component surfaces both on the interior and the exterior.

#### **SAMPLING PROTOCOL**

Lead-based paint sampling is done using a Niton XLp Spectrum Lead Detector (Model 300A) X-ray Fluorescence (XRF) instrument. This device uses a radioactive source that releases photons of energy onto a painted surface. The emitted photon causes a characteristic wavelength of energy to be released. The instrument then measures the energy release to determine if lead is present and at what amount. Substrate correction is not necessary with this instrument, and it can penetrate 20 layers of paint.

The lead summary of findings identifies building components that tested positive for lead-based paint. The XRF analysis sheets have identified testing areas. The sheets have reading number, then list component tested, substrate, side, condition, color, room, unit number and result. (Color listed is the visible color and may not be the color of the paint that contains lead.) No device at present can differentiate what layer or layers of paint on a surface actually is/are the layer or layers that contain lead. The results are reported as positive or negative in comparison to the standard of 1.0 mg/cm<sup>2</sup>. A negative result does not necessarily mean that no lead is present in the paint, but that the amount of lead in the paint is less than 1.0 mg/cm<sup>2</sup>.

# **SECTION 2**



**LEAD SUMMARY OF FINDINGS  
(POSITIVE MATERIALS)**

**PIKE COUNTY HOUSING AUTHORITY  
PITTSFIELD UNITS  
PITTSFIELD, ILLINOIS**

**INTERIOR**

NO COMPONENT TESTED POSITIVE

**EXTERIOR**

EXPOSED PAINTED WOOD TRIM  
ORIGINAL PAINTED WOOD COMPONENTS UNDER STEEL AND VINYL

# **SECTION 3**

PIKE COUNTY HOUSING AUTHORITY  
PITTSFIELD

Reading #	Component	Substrate	Side	Condition	Color	Room	Unit #	Results	PbC
1	Self Calibrate								6.68
2	Calibrate								1
3	Calibrate								0.9
4	Calibrate								1
5	Wall	Gypsum	A	Intact	Ivory	Living Room	302	Negative	< LOD
6	Wall	Gypsum	B	Intact	Ivory	Living Room	302	Negative	< LOD
7	Wall	Gypsum	C	Intact	Ivory	Living Room	302	Negative	< LOD
8	Wall	Gypsum	D	Intact	Ivory	Living Room	302	Negative	< LOD
9	Ceiling	Gypsum		Intact	White	Living Room	302	Negative	< LOD
10	Window Casing	Metal	A	Intact	White	Living Room	302	Negative	< LOD
11	Window Sash	Metal	A	Intact	White	Living Room	302	Negative	< LOD
12	Jamb	Metal	A	Intact	White	Living Room	302	Negative	< LOD
13	Door	Metal	A	Intact	White	Living Room	302	Negative	< LOD
14	Shelf	Metal	C	Intact	White	Kitchen	302	Negative	< LOD
15	Trim	Wood		Intact	Ivory	Kitchen	302	Negative	< LOD
16	Wall	Gypsum	A	Intact	Ivory	Kitchen	302	Negative	< LOD
17	Wall	Gypsum	B	Intact	Ivory	Kitchen	302	Negative	< LOD
18	Wall	Gypsum	C	Intact	Ivory	Kitchen	302	Negative	< LOD
19	Wall	Gypsum	D	Intact	Ivory	Kitchen	302	Negative	< LOD
20	Cabinet	Wood	D	Intact	Ivory	Kitchen	302	Negative	< LOD
21	Door Stop	Metal	C	Intact	Ivory	Kitchen	302	Negative	< LOD
22	Wall	Gypsum	A	Intact	Ivory	Bedroom	302	Negative	< LOD
23	Wall	Gypsum	B	Intact	Ivory	Bedroom	302	Negative	< LOD
24	Wall	Gypsum	C	Intact	Ivory	Bedroom	302	Negative	< LOD
25	Wall	Gypsum	D	Intact	Ivory	Bedroom	302	Negative	< LOD
26	Ceiling	Gypsum		Intact	White	Bedroom	302	Negative	< LOD
27	Door	Wood	D	Intact	Ivory	Bedroom	302	Negative	< LOD
28	Jamb	Wood	D	Intact	Ivory	Bedroom	302	Negative	< LOD
29	Shelf	Metal	D	Intact	Ivory	Bedroom	302	Negative	< LOD
30	Door Stop	Metal	D	Intact	Ivory	Bedroom	302	Negative	< LOD
31	Wall	Gypsum	A	Intact	Ivory	Bedroom	302	Negative	< LOD
32	Wall	Gypsum	B	Intact	Ivory	Bedroom	302	Negative	< LOD
33	Wall	Gypsum	C	Intact	Ivory	Bedroom	302	Negative	< LOD
34	Wall	Gypsum	D	Intact	Ivory	Bedroom	302	Negative	< LOD
35	Ceiling	Gypsum		Intact	White	Bedroom	302	Negative	< LOD
36	Door Stop	Metal	B	Intact	Ivory	Bedroom	302	Negative	< LOD
37	Shelf Support	Wood	B	Intact	Ivory	Bedroom	302	Negative	< LOD
38	Window Casing	Metal	C	Intact	White	Bedroom	302	Negative	< LOD
39	Window Sash	Metal	C	Intact	White	Bedroom	302	Negative	< LOD
40	Door	Wood	A	Intact	Ivory	Bedroom	302	Negative	< LOD
41	Jamb	Wood	A	Intact	Ivory	Bedroom	302	Negative	< LOD

LOD = LIMIT OF DETECTION

PIKE COUNTY HOUSING AUTHORITY  
PITTSFIELD

Reading #	Component	Substrate	Side	Condition	Color	Room	Unit #	Results	PbC
42	Wall	Gypsum	A	Intact	Ivory	Bathroom	302	Negative	< LOD
43	Wall	Gypsum	B	Intact	Ivory	Bathroom	302	Negative	< LOD
44	Wall	Gypsum	C	Intact	Ivory	Bathroom	302	Negative	< LOD
45	Wall	Gypsum	D	Intact	Ivory	Bathroom	302	Negative	< LOD
46	Ceiling	Gypsum		Intact	Ivory	Bathroom	302	Negative	< LOD
47	Door Casing	Wood	B	Intact	Ivory	Bathroom	302	Negative	< LOD
48	Door	Wood	B	Intact	Ivory	Bathroom	302	Negative	< LOD
49	Wall	Gypsum	A	Intact	Ivory	Living Room	304	Negative	< LOD
50	Wall	Gypsum	B	Intact	Ivory	Living Room	304	Negative	< LOD
51	Wall	Gypsum	C	Intact	Ivory	Living Room	304	Negative	< LOD
52	Wall	Gypsum	D	Intact	Ivory	Living Room	304	Negative	< LOD
53	Ceiling	Gypsum		Intact	Ivory	Living Room	304	Negative	< LOD
54	Door Casing	Metal	D	Intact	Ivory	Living Room	304	Negative	< LOD
55	Door	Metal	D	Intact	Ivory	Living Room	304	Negative	< LOD
56	Window Sash	Metal	A	Intact	Ivory	Living Room	304	Negative	< LOD
57	Window Casing	Metal	A	Intact	Ivory	Living Room	304	Negative	< LOD
58	Wall	Gypsum	A	Intact	Ivory	Kitchen	304	Negative	< LOD
59	Wall	Gypsum	B	Intact	Ivory	Kitchen	304	Negative	< LOD
60	Wall	Gypsum	C	Intact	Ivory	Kitchen	304	Negative	< LOD
61	Wall	Gypsum	D	Intact	Ivory	Kitchen	304	Negative	< LOD
62	Cabinet	Wood	C	Intact	Varnish	Kitchen	304	Negative	< LOD
63	Door Stop	Metal	C	Intact	Ivory	Kitchen	304	Negative	< LOD
64	Shelf	Metal	C	Intact	Ivory	Kitchen	304	Negative	< LOD
65	Wall	Gypsum	A	Intact	Ivory	Bedroom	304	Negative	< LOD
66	Wall	Gypsum	B	Intact	Ivory	Bedroom	304	Negative	< LOD
67	Wall	Gypsum	C	Intact	Ivory	Bedroom	304	Negative	< LOD
68	Wall	Gypsum	D	Intact	Ivory	Bedroom	304	Negative	< LOD
69	Ceiling	Gypsum		Intact	Ivory	Bedroom	304	Negative	< LOD
70	Door Stop	Metal	B	Intact	Ivory	Bedroom	304	Negative	< LOD
71	Shelf	Metal	B	Intact	Ivory	Bedroom	304	Negative	< LOD
72	Window Sash	Metal	C	Intact	Ivory	Bedroom	304	Negative	< LOD
73	Window Casing	Metal	C	Intact	Ivory	Bedroom	304	Negative	< LOD
74	Wall	Gypsum	A	Intact	Ivory	Bedroom	304	Negative	< LOD
75	Wall	Gypsum	B	Intact	Ivory	Bedroom	304	Negative	< LOD
76	Wall	Gypsum	C	Intact	Ivory	Bedroom	304	Negative	< LOD
77	Wall	Gypsum	D	Intact	Ivory	Bedroom	304	Negative	< LOD
78	Ceiling	Gypsum		Intact	Ivory	Bedroom	304	Negative	< LOD
79	Door Stop	Metal	D	Intact	Ivory	Bedroom	304	Negative	< LOD
80	Shelf	Metal	D	Intact	Ivory	Bedroom	304	Negative	< LOD
81	Door Casing	Wood	A	Intact	Ivory	Bedroom	304	Negative	< LOD
82	Door	Wood	A	Intact	Varnish	Bedroom	304	Negative	< LOD

LOD = LIMIT OF DETECTION



PIKE COUNTY HOUSING AUTHORITY  
PITTSFIELD

Reading #	Component	Substrate	Side	Condition	Color	Room	Unit #	Results	PbC
83	Jamb	Wood	D	Intact	Ivory	Bathroom	304	Negative	< LOD
84	Door	Wood	D	Intact	Varnish	Bathroom	304	Negative	< LOD
85	Wall	Gypsum	A	Intact	Ivory	Bathroom	304	Negative	< LOD
86	Wall	Gypsum	B	Intact	Ivory	Bathroom	304	Negative	< LOD
87	Wall	Gypsum	C	Intact	Ivory	Bathroom	304	Negative	< LOD
88	Wall	Gypsum	D	Intact	Ivory	Bathroom	304	Negative	< LOD
89	Ceiling	Gypsum		Intact	Ivory	Bathroom	304	Negative	< LOD
90	Soffet	Metal	A	Intact	White	Exterior	CC	Negative	< LOD
91	Facia	Metal	A	Intact	White	Exterior	CC	Negative	< LOD
92	Trim	Wood	A	Intact	White	Exterior	CC	Negative	< LOD
<b>93</b>	<b>Wood Trim</b>	<b>Wood</b>	<b>A</b>	<b>Peeling</b>	<b>White</b>	<b>Exterior</b>	<b>CC</b>	<b>Positive</b>	<b>1.8</b>
94	Down Spout	Metal	A	Intact	White	Exterior	CC	Negative	< LOD
95	Wall	Gypsum	A	Intact	Ivory	Living Room	312	Negative	< LOD
96	Wall	Gypsum	B	Intact	Ivory	Living Room	312	Negative	< LOD
97	Wall	Gypsum	C	Intact	Ivory	Living Room	312	Negative	< LOD
98	Wall	Gypsum	D	Intact	Ivory	Living Room	312	Negative	< LOD
99	Ceiling	Gypsum		Intact	Ivory	Living Room	312	Negative	< LOD
100	Window Sash	Metal	A	Intact	White	Living Room	312	Negative	< LOD
101	Window Casing	Metal	A	Intact	White	Living Room	312	Negative	< LOD
102	Jamb	Metal	B	Intact	Ivory	Living Room	312	Negative	< LOD
103	Door	Metal	B	Intact	Ivory	Living Room	312	Negative	< LOD
104	Door Casing	Metal	C	Intact	Ivory	Living Room	312	Negative	< LOD
105	Door	Metal	C	Intact	Ivory	Living Room	312	Negative	< LOD
106	Wall	Gypsum	A	Intact	Ivory	Kitchen	312	Negative	< LOD
107	Wall	Gypsum	B	Intact	Ivory	Kitchen	312	Negative	< LOD
108	Wall	Gypsum	C	Intact	Ivory	Kitchen	312	Negative	< LOD
109	Wall	Gypsum	D	Intact	Ivory	Kitchen	312	Negative	< LOD
110	Cabinet	Wood	B	Intact	Varnish	Kitchen	312	Negative	< LOD
111	Door	Metal	C	Intact	White	Kitchen	312	Negative	< LOD
112	Jamb	Metal	C	Intact	White	Kitchen	312	Negative	< LOD
113	Shelf	Wood	C	Intact	Ivory	Kitchen	312	Negative	< LOD
114	Wall	Gypsum	A	Intact	Ivory	Bathroom	312	Negative	< LOD
115	Wall	Gypsum	B	Intact	Ivory	Bathroom	312	Negative	< LOD
116	Wall	Gypsum	C	Intact	Ivory	Bathroom	312	Negative	< LOD
117	Wall	Gypsum	D	Intact	Ivory	Bathroom	312	Negative	< LOD
118	Ceiling	Gypsum		Intact	Ivory	Bathroom	312	Negative	< LOD
119	Door Casing	Wood	A	Intact	Ivory	Bathroom	312	Negative	< LOD
120	Door	Wood	A	Intact	Ivory	Bathroom	312	Negative	< LOD
121	Chair Rail	Wood	B	Intact	Ivory	Bathroom	312	Negative	< LOD
122	Chair Rail	Wood	D	Intact	Ivory	Bathroom	312	Negative	< LOD
123	Wall	Gypsum	A	Intact	Ivory	Bedroom	312	Negative	< LOD

LOD = LIMIT OF DETECTION

PIKE COUNTY HOUSING AUTHORITY  
PITTSFIELD

Reading #	Component	Substrate	Side	Condition	Color	Room	Unit #	Results	PbC
124	Wall	Gypsum	B	Intact	Ivory	Bedroom	312	Negative	< LOD
125	Wall	Gypsum	C	Intact	Ivory	Bedroom	312	Negative	< LOD
126	Wall	Gypsum	D	Intact	Ivory	Bedroom	312	Negative	< LOD
127	Ceiling	Gypsum		Intact	Ivory	Bedroom	312	Negative	< LOD
128	Window Casing	Metal	C	Intact	Ivory	Bedroom	312	Negative	< LOD
129	Window Sash	Metal	C	Intact	Ivory	Bedroom	312	Negative	< LOD
130	Shelf	Wood	A	Intact	Ivory	Bedroom	312	Negative	< LOD
131	Door Casing	Wood	D	Intact	Ivory	Bedroom	312	Negative	< LOD
132	Door	Wood	D	Intact	Varnish	Bedroom	312	Negative	< LOD
133	Wall	Gypsum	C	Intact	Ivory	Bedroom	312	Negative	< LOD
134	Wall	Gypsum	A	Intact	Ivory	Bedroom	312	Negative	< LOD
135	Wall	Gypsum	B	Intact	Ivory	Bedroom	312	Negative	< LOD
136	Wall	Gypsum	D	Intact	Ivory	Bedroom	312	Negative	< LOD
137	Ceiling	Gypsum		Intact	Ivory	Bedroom	312	Negative	< LOD
138	Window Casing	Wood	A	Intact	Ivory	Bedroom	312	Negative	< LOD
139	Window Sash	Metal	A	Intact	Ivory	Bedroom	312	Negative	< LOD
140	shelf	Wood	C	Intact	Ivory	Bedroom	312	Negative	< LOD
141	Door Casing	Wood	D	Intact	Ivory	Bedroom	312	Negative	< LOD
142	Door	Wood	D	Intact	Varnish	Bedroom	312	Negative	< LOD
143	Soffet	Metal	A	Intact	White	Bedroom	312	Negative	< LOD
144	Facia	Metal	A	Intact	White	Exterior	AA-1	Negative	< LOD
145	Window	Wood	A	Intact	White	Exterior	AA-1	Negative	0.6
146	Window	Wood	A	Intact	White	Exterior	AA-1	Negative	0.5
147	Wood Trim	Wood	A	Intact	White	Exterior	AA-1	Negative	0.7
<b>148</b>	<b>Wood Trim</b>	<b>Wood</b>	<b>A</b>	<b>Intact</b>	<b>White</b>	<b>Exterior</b>	<b>AA-1</b>	<b>Positive</b>	<b>1</b>
149	Down Spout	Metal	A	Intact	White	Exterior	AA-1	Negative	< LOD
150	Trim	Metal	D	Intact	White	Exterior	AA-1	Negative	< LOD
151	Hand Rail	Metal	A	Intact	Gray	Exterior	AA-1	Negative	< LOD
152	Step	Concrete	A	Intact	Yellow	Exterior	AA-1	Negative	< LOD
153	Wall	Gypsum	A	Intact	Ivory	Living Room	316	Negative	< LOD
154	Wall	Gypsum	B	Intact	Ivory	Living Room	316	Negative	< LOD
155	Wall	Gypsum	C	Intact	Ivory	Living Room	316	Negative	< LOD
156	Wall	Gypsum	D	Intact	Ivory	Living Room	316	Negative	< LOD
157	Ceiling	Gypsum		Intact	Ivory	Living Room	316	Negative	< LOD
158	Jamb	Metal	D	Intact	Ivory	Living Room	316	Negative	< LOD
159	Door	Metal	D	Intact	Ivory	Living Room	316	Negative	< LOD
160	Window Casing	Metal	A	Intact	White	Living Room	316	Negative	< LOD
161	Window Sash	Metal	A	Intact	White	Living Room	316	Negative	< LOD
162	Window Casing	Metal	A	Intact	White	Kitchen	316	Negative	< LOD
163	Window Sash	Metal	A	Intact	White	Kitchen	316	Negative	< LOD
164	Wall	Gypsum	A	Intact	Ivory	Kitchen	316	Negative	< LOD

LOD = LIMIT OF DETECTION

PIKE COUNTY HOUSING AUTHORITY  
PITTSFIELD

Reading #	Component	Substrate	Side	Condition	Color	Room	Unit #	Results	PbC
165	Wall	Gypsum	B	Intact	Ivory	Kitchen	316	Negative	< LOD
166	Wall	Gypsum	C	Intact	Ivory	Kitchen	316	Negative	< LOD
167	Wall	Gypsum	D	Intact	Ivory	Kitchen	316	Negative	< LOD
168	Cabinet	Wood	B	Intact	Varnish	Kitchen	316	Negative	< LOD
169	Door Casing	Wood	B	Intact	Ivory	Bedroom	316	Negative	< LOD
170	Door	Wood	B	Intact	Varnish	Bedroom	316	Negative	< LOD
171	Wall	Gypsum	A	Intact	Ivory	Bedroom	316	Negative	< LOD
172	Wall	Gypsum	B	Intact	Ivory	Bedroom	316	Negative	< LOD
173	Wall	Gypsum	C	Intact	Ivory	Bedroom	316	Negative	< LOD
174	Wall	Gypsum	D	Intact	Ivory	Bedroom	316	Negative	< LOD
175	Ceiling	Gypsum		Intact	Ivory	Bedroom	316	Negative	< LOD
176	Shelf	Metal	B	Intact	Ivory	Bedroom	316	Negative	< LOD
177	Door Stop	Metal	B	Intact	Ivory	Bedroom	316	Negative	< LOD
178	Jamb	Wood	A	Intact	Ivory	Bedroom	316	Negative	< LOD
179	Door	Wood	A	Intact	Varnish	Bedroom	316	Negative	< LOD
180	Wall	Gypsum	A	Intact	Ivory	Bedroom	316	Negative	< LOD
181	Wall	Gypsum	D	Intact	Ivory	Bedroom	316	Negative	< LOD
182	Wall	Gypsum	C	Intact	Ivory	Bedroom	316	Negative	< LOD
183	Ceiling	Gypsum		Intact	Ivory	Bedroom	316	Negative	< LOD
184	Window Casing	Metal	C	Intact	White	Bedroom	316	Negative	< LOD
185	Window Sash	Metal	C	Intact	White	Bedroom	316	Negative	< LOD
186	Door	Wood	D	Intact	Varnish	Bathroom	316	Negative	< LOD
187	Jamb	Wood	D	Intact	Ivory	Bathroom	316	Negative	< LOD
188	Wall	Gypsum	A	Intact	Ivory	Bathroom	316	Negative	< LOD
189	Wall	Gypsum	D	Intact	Ivory	Bathroom	316	Negative	< LOD
190	Wall	Gypsum	C	Intact	Ivory	Bathroom	316	Negative	< LOD
191	Wall	Gypsum	B	Intact	Ivory	Bathroom	316	Negative	< LOD
192	Ceiling	Gypsum		Intact	Ivory	Bathroom	316	Negative	< LOD
193	Trim	Metal	A	Intact	Ivory	Exterior	BB-1	Negative	< LOD
194	<b>Wood Trim</b>	<b>Wood</b>	<b>A</b>	<b>Intact</b>	<b>Ivory</b>	<b>Exterior</b>	<b>BB-1</b>	<b>Positive</b>	<b>1.2</b>
195	Facia	Metal	A	Intact	Ivory	Exterior	BB-1	Negative	< LOD
196	Soffet	Metal	A	Intact	Ivory	Exterior	BB-1	Negative	< LOD
197	Down Spout	Metal	A	Intact	Ivory	Exterior	BB-1	Negative	< LOD
198	Wall	Gypsum	A	Intact	Ivory	Living / Kitchen	320	Negative	< LOD
199	Wall	Gypsum	B	Intact	Ivory	Living / Kitchen	320	Negative	< LOD
200	Wall	Gypsum	C	Intact	Ivory	Living / Kitchen	320	Negative	< LOD
201	Wall	Gypsum	D	Intact	Ivory	Living / Kitchen	320	Negative	< LOD
202	Ceiling	Gypsum		Intact	White	Living / Kitchen	320	Negative	< LOD
203	Jamb	Metal	B	Intact	Ivory	Living / Kitchen	320	Negative	< LOD
204	Door	Metal	B	Intact	White	Living / Kitchen	320	Negative	< LOD
205	Window Casing	Metal	A	Intact	White	Living / Kitchen	320	Negative	< LOD

LOD = LIMIT OF DETECTION

PIKE COUNTY HOUSING AUTHORITY  
PITTSFIELD

Reading #	Component	Substrate	Side	Condition	Color	Room	Unit #	Results	PbC
206	Window Sash	Metal	A	Intact	White	Living / Kitchen	320	Negative	< LOD
207	Jamb	Metal	D	Intact	Ivory	Bedroom	320	Negative	< LOD
208	Door	Wood	D	Intact	Ivory	Bedroom	320	Negative	< LOD
209	Jamb	Wood	D	Intact	Ivory	Bedroom	320	Negative	< LOD
210	Wall	Gypsum	A	Intact	Ivory	Bedroom	320	Negative	< LOD
211	Wall	Gypsum	B	Intact	Ivory	Bedroom	320	Negative	< LOD
212	Wall	Gypsum	C	Intact	Ivory	Bedroom	320	Negative	< LOD
213	Wall	Gypsum	D	Intact	Ivory	Bedroom	320	Negative	< LOD
214	Ceiling	Gypsum		Intact	Ivory	Bedroom	320	Negative	< LOD
215	Window Casing	Metal	C	Intact	Ivory	Bedroom	320	Negative	< LOD
216	Window Sash	Metal	C	Intact	Ivory	Bedroom	320	Negative	< LOD
217	Door	Wood	D	Intact	Varnish	Bathroom	320	Negative	< LOD
218	Jamb	Wood	D	Intact	Ivory	Bathroom	320	Negative	< LOD
219	Wall	Gypsum	A	Intact	Ivory	Bathroom	320	Negative	< LOD
220	Wall	Gypsum	D	Intact	Ivory	Bathroom	320	Negative	< LOD
221	Wall	Gypsum	C	Intact	Ivory	Bathroom	320	Negative	< LOD
222	Wall	Gypsum	B	Intact	Ivory	Bathroom	320	Negative	< LOD
223	Ceiling	Gypsum		Intact	Ivory	Bathroom	320	Negative	< LOD
224	Chair Rail	Wood	A	Intact	Ivory	Bathroom	320	Negative	< LOD
225	Wall	Gypsum	A	Intact	Ivory	Living / Kitchen	322	Negative	< LOD
226	Wall	Gypsum	B	Intact	Ivory	Living / Kitchen	322	Negative	< LOD
227	Wall	Gypsum	C	Intact	Ivory	Living / Kitchen	322	Negative	< LOD
228	Wall	Gypsum	D	Intact	Ivory	Living / Kitchen	322	Negative	< LOD
229	Ceiling	Gypsum		Intact	Ivory	Living / Kitchen	322	Negative	< LOD
230	Stop	Metal	C	Intact	Ivory	Living / Kitchen	322	Negative	< LOD
231	Shelf	Metal	C	Intact	Varnish	Living / Kitchen	322	Negative	< LOD
232	Cabinet	Wood	D	Intact	Ivory	Living / Kitchen	322	Negative	< LOD
233	Casing	Wood	A	Intact	Ivory	Living / Kitchen	322	Negative	< LOD
234	Door Stop	Wood	A	Intact	Ivory	Living / Kitchen	322	Negative	< LOD
235	Door Casing	Metal	D	Intact	Ivory	Living / Kitchen	322	Negative	< LOD
236	Door	Metal	D	Intact	Ivory	Living / Kitchen	322	Negative	< LOD
237	Door	Wood	A	Intact	Ivory	Bedroom	322	Negative	< LOD
238	Jamb	Wood	A	Intact	Ivory	Bedroom	322	Negative	< LOD
239	Wall	Gypsum	A	Intact	Ivory	Bedroom	322	Negative	< LOD
240	Wall	Gypsum	B	Intact	Ivory	Bedroom	322	Negative	< LOD
241	Wall	Gypsum	C	Intact	Ivory	Bedroom	322	Negative	< LOD
242	Wall	Gypsum	D	Intact	Ivory	Bedroom	322	Negative	< LOD
243	Ceiling	Gypsum		Intact	Ivory	Bedroom	322	Negative	< LOD
244	Shelf Support	Wood	A	Intact	Ivory	Bedroom	322	Negative	< LOD
245	Window Casing	Metal	C	Intact	Ivory	Bedroom	322	Negative	< LOD
246	Window Sash	Metal	C	Intact	Ivory	Bedroom	322	Negative	< LOD

LOD = LIMIT OF DETECTION



PIKE COUNTY HOUSING AUTHORITY  
PITTSFIELD

Reading #	Component	Substrate	Side	Condition	Color	Room	Unit #	Results	PbC
247	Door	Wood	B	Intact	Ivory	Bathroom	322	Negative	< LOD
248	Jamb	Wood	B	Intact	Ivory	Bathroom	322	Negative	< LOD
249	Wall	Gypsum	A	Intact	Ivory	Bathroom	322	Negative	< LOD
250	Wall	Gypsum	B	Intact	Ivory	Bathroom	322	Negative	< LOD
251	Wall	Gypsum	C	Intact	Ivory	Bathroom	322	Negative	< LOD
252	Wall	Gypsum	D	Intact	Ivory	Bathroom	322	Negative	< LOD
253	Ceiling	Gypsum		Intact	White	Bathroom	322	Negative	< LOD
254	Wall	Gypsum	A	Intact	Ivory	Living / Kitchen	324	Negative	< LOD
255	Wall	Gypsum	D	Intact	Ivory	Living / Kitchen	324	Negative	< LOD
256	Wall	Gypsum	C	Intact	Ivory	Living / Kitchen	324	Negative	< LOD
257	Wall	Gypsum	B	Intact	Ivory	Living / Kitchen	324	Negative	< LOD
258	Ceiling	Gypsum		Intact	Ivory	Living / Kitchen	324	Negative	< LOD
259	Cabinet	Wood	B	Intact	Varnish	Living / Kitchen	324	Negative	< LOD
260	Door Stop	Metal	C	Intact	Ivory	Living / Kitchen	324	Negative	< LOD
261	Shelf	Metal	C	Intact	Ivory	Living / Kitchen	324	Negative	< LOD
262	Jamb	Metal	B	Intact	Ivory	Living / Kitchen	324	Negative	< LOD
263	Door	Metal	B	Intact	Ivory	Bedroom	324	Negative	< LOD
264	Jamb	Metal	A	Intact	Ivory	Bedroom	324	Negative	< LOD
265	Door	Wood	A	Intact	Ivory	Bedroom	324	Negative	< LOD
266	Wall	Gypsum	A	Intact	Ivory	Bedroom	324	Negative	< LOD
267	Wall	Gypsum	B	Intact	Ivory	Bedroom	324	Negative	< LOD
268	Wall	Gypsum	C	Intact	Ivory	Bedroom	324	Negative	< LOD
269	Wall	Gypsum	D	Intact	Ivory	Bedroom	324	Negative	< LOD
270	Ceiling	Gypsum		Intact	Ivory	Bedroom	324	Negative	< LOD
271	Window Casing	Metal	C	Intact	Ivory	Bedroom	324	Negative	< LOD
272	Window Sash	Metal	C	Intact	Ivory	Bedroom	324	Negative	< LOD
273	Stop	Metal	A	Intact	Ivory	Bedroom	324	Negative	< LOD
274	Shelf	Wood	A	Intact	Ivory	Bedroom	324	Negative	< LOD
275	Jamb	Wood	D	Intact	Ivory	Bathroom	324	Negative	< LOD
276	Door	Wood	D	Intact	Varnish	Bathroom	324	Negative	< LOD
277	Wall	Gypsum	A	Intact	Ivory	Bathroom	324	Negative	< LOD
278	Wall	Gypsum	B	Intact	Ivory	Bathroom	324	Negative	< LOD
279	Wall	Gypsum	C	Intact	Ivory	Bathroom	324	Negative	< LOD
280	Wall	Gypsum	D	Intact	Ivory	Bathroom	324	Negative	< LOD
281	Ceiling	Gypsum		Intact	Ivory	Bathroom	324	Negative	< LOD
282	Window Casing	Wood	A	Intact	Ivory	Living / Kitchen	324	Negative	< LOD
283	Window Stop	Wood	A	Intact	Ivory	Living / Kitchen	324	Negative	< LOD
284	Soffet	Metal	A	Intact	White	Exterior	BB-1	Negative	< LOD
285	Facia	Metal	A	Intact	White	Exterior	BB-1	Negative	< LOD
286	Gutter	Metal	A	Intact	White	Exterior	BB-1	Negative	< LOD
287	W Trim	Wood	A	Intact	White	Exterior	BB-1	Negative	0.5

LOD = LIMIT OF DETECTION



PIKE COUNTY HOUSING AUTHORITY  
PITTSFIELD

Reading #	Component	Substrate	Side	Condition	Color	Room	Unit #	Results	PbC
288	W Trim	Wood	A	Intact	White	Exterior	BB-1	Negative	0.19
289	Window	Wood	A	Intact	White	Exterior	BB-1	Negative	0.3
290	Trim	Metal	A	Intact	White	Exterior	BB-1	Negative	< LOD
291	Wall	Gypsum	A	Intact	Ivory	Living / Kitchen	332	Negative	< LOD
292	Wall	Gypsum	B	Intact	Ivory	Living / Kitchen	332	Negative	< LOD
293	Wall	Gypsum	C	Intact	Ivory	Living / Kitchen	332	Negative	< LOD
294	Wall	Gypsum	D	Intact	Ivory	Living / Kitchen	332	Negative	< LOD
295	Ceiling	Gypsum		Intact	White	Living / Kitchen	332	Negative	< LOD
296	Window Casing	Metal	A	Intact	Ivory	Living / Kitchen	332	Negative	< LOD
297	Window Sash	Metal	A	Intact	Ivory	Living / Kitchen	332	Negative	< LOD
298	Jamb	Metal	B	Intact	Ivory	Living / Kitchen	332	Negative	< LOD
299	Door	Metal	B	Intact	Ivory	Living / Kitchen	332	Negative	< LOD
300	Cabinet	Wood	B	Intact	Varnish	Living / Kitchen	332	Negative	< LOD
301	Shelf	Metal	C	Intact	Ivory	Living / Kitchen	332	Negative	< LOD
302	Door Stop	Metal	C	Intact	Ivory	Living / Kitchen	332	Negative	< LOD
303	Door	Wood	A	Intact	Ivory	Bedroom	332	Negative	< LOD
304	Jamb	Wood	A	Intact	Ivory	Bedroom	332	Negative	< LOD
305	Wall	Gypsum	A	Intact	Ivory	Bedroom	332	Negative	< LOD
306	Wall	Gypsum	B	Intact	Ivory	Bedroom	332	Negative	< LOD
307	Wall	Gypsum	C	Intact	Ivory	Bedroom	332	Negative	< LOD
308	Wall	Gypsum	D	Intact	Ivory	Bedroom	332	Negative	< LOD
309	Ceiling	Gypsum		Intact	Ivory	Bedroom	332	Negative	< LOD
310	Door Stop	Metal	A	Intact	Ivory	Bedroom	332	Negative	< LOD
311	Window Casing	Metal	D	Intact	Ivory	Bedroom	332	Negative	< LOD
312	Window Sash	Metal	D	Intact	Ivory	Bedroom	332	Negative	< LOD
313	Door	Wood	D	Intact	Ivory	Bathroom	332	Negative	< LOD
314	Door Casing	Wood	D	Intact	Ivory	Bathroom	332	Negative	< LOD
315	Wall	Gypsum	A	Intact	Ivory	Bathroom	332	Negative	< LOD
316	Wall	Gypsum	B	Intact	Ivory	Bathroom	332	Negative	< LOD
317	Wall	Gypsum	C	Intact	Ivory	Bathroom	332	Negative	< LOD
318	Wall	Gypsum	D	Intact	Ivory	Bathroom	332	Negative	< LOD
319	Ceiling	Gypsum		Intact	Ivory	Bathroom	332	Negative	< LOD
320	Soffet	Metal	A	Intact	White	Exterior	AA-2	Negative	< LOD
321	Facia	Metal	A	Intact	White	Exterior	AA-2	Negative	< LOD
322	Trim	Metal	A	Intact	White	Exterior	AA-2	Negative	< LOD
323	Down Spout	Metal	A	Intact	White	Exterior	AA-2	Negative	< LOD
324	Window Casing	Wood	A	Intact	White	Exterior	AA-2	Negative	0.6
325	Wall	Gypsum	A	Intact	Ivory	Living / Kitchen	334	Negative	< LOD
326	Wall	Gypsum	B	Intact	Ivory	Living / Kitchen	334	Negative	< LOD
327	Wall	Gypsum	C	Intact	Ivory	Living / Kitchen	334	Negative	< LOD
328	Wall	Gypsum	D	Intact	Ivory	Living / Kitchen	334	Negative	< LOD

LOD = LIMIT OF DETECTION

PIKE COUNTY HOUSING AUTHORITY  
PITTSFIELD

Reading #	Component	Substrate	Side	Condition	Color	Room	Unit #	Results	PbC
329	Ceiling	Gypsum		Intact	Ivory	Living / Kitchen	334	Negative	< LOD
330	Door Stop	Metal	C	Intact	Ivory	Living / Kitchen	334	Negative	< LOD
331	Shelf	Metal	C	Intact	Ivory	Living / Kitchen	334	Negative	< LOD
332	Cabinet	Wood	D	Intact	Varnish	Living / Kitchen	334	Negative	< LOD
333	Casing	Metal	A	Intact	Ivory	Living / Kitchen	334	Negative	< LOD
334	Window Casing	Wood	A	Intact	White	Living / Kitchen	334	Negative	< LOD
335	Window	Wood	A	Intact	White	Living / Kitchen	334	Negative	0.7
336	Door	Metal	D	Intact	Ivory	Living / Kitchen	334	Negative	< LOD
337	Door Casing	Metal	D	Intact	Ivory	Living / Kitchen	334	Negative	< LOD
338	Door	Wood	A	Intact	Varnish	Bedroom	334	Negative	< LOD
339	Jamb	Wood	A	Intact	Ivory	Bedroom	334	Negative	< LOD
340	Wall	Gypsum	A	Intact	Ivory	Bedroom	334	Negative	< LOD
341	Wall	Gypsum	B	Intact	Ivory	Bedroom	334	Negative	< LOD
342	Wall	Gypsum	C	Intact	Ivory	Bedroom	334	Negative	< LOD
343	Wall	Gypsum	D	Intact	Ivory	Bedroom	334	Negative	< LOD
344	Ceiling	Gypsum		Intact	Ivory	Bedroom	334	Negative	< LOD
345	Stop	Metal	A	Intact	Ivory	Bedroom	334	Negative	< LOD
346	Shelf	Metal	A	Intact	Ivory	Bedroom	334	Negative	< LOD
347	Door	Wood	B	Intact	Ivory	Bathroom	334	Negative	< LOD
348	Jamb	Wood	B	Intact	Ivory	Bathroom	334	Negative	< LOD
349	Wall	Gypsum	A	Intact	Ivory	Bathroom	334	Negative	< LOD
350	Wall	Gypsum	B	Intact	Ivory	Bathroom	334	Negative	< LOD
351	Wall	Gypsum	C	Intact	Ivory	Bathroom	334	Negative	< LOD
352	Wall	Gypsum	D	Intact	Ivory	Bathroom	334	Negative	< LOD
353	Ceiling	Gypsum		Intact	Ivory	Bathroom	334	Negative	< LOD
354	Soffet	Metal	A	Intact	White	Exterior	AA-1	Negative	< LOD
355	Facia	Metal	A	Intact	White	Exterior	AA-1	Negative	< LOD
356	Gutter	Metal	A	Intact	White	Exterior	AA-1	Negative	< LOD
357	Trim	Metal	A	Intact	White	Exterior	AA-1	Negative	< LOD
<b>358</b>	<b>Wood Trim</b>	<b>Wood</b>	<b>A</b>	<b>Peeling</b>	<b>White</b>	<b>Exterior</b>	<b>AA-1</b>	<b>Positive</b>	<b>1</b>
359	Wall	Gypsum	A	Intact	Ivory	Living Room	346	Negative	< LOD
360	Wall	Gypsum	D	Intact	Ivory	Living Room	346	Negative	< LOD
361	Wall	Gypsum	C	Intact	Ivory	Living Room	346	Negative	< LOD
362	Wall	Gypsum	B	Intact	Ivory	Living Room	346	Negative	< LOD
363	Ceiling	Gypsum		Intact	Ivory	Living Room	346	Negative	< LOD
364	Casing	Wood	C	Intact	Ivory	Living Room	346	Negative	< LOD
365	Door	Metal	C	Intact	White	Living Room	346	Negative	< LOD
366	Jamb	Metal	B	Intact	Ivory	Living Room	346	Negative	< LOD
367	Door	Metal	B	Intact	Ivory	Living Room	346	Negative	< LOD
368	Wall	Gypsum	A	Intact	Ivory	Kitchen	346	Negative	< LOD
369	Wall	Gypsum	B	Intact	Ivory	Kitchen	346	Negative	< LOD

LOD = LIMIT OF DETECTION

PIKE COUNTY HOUSING AUTHORITY  
PITTSFIELD

Reading #	Component	Substrate	Side	Condition	Color	Room	Unit #	Results	PbC
370	Wall	Gypsum	C	Intact	Ivory	Kitchen	346	Negative	< LOD
371	Wall	Gypsum	D	Intact	Ivory	Kitchen	346	Negative	< LOD
372	Cabinet	Wood	B	Intact	Varnish	Kitchen	346	Negative	< LOD
373	Jamb	Metal	C	Intact	Ivory	Kitchen	346	Negative	< LOD
374	Door	Metal	C	Intact	Ivory	Kitchen	346	Negative	< LOD
375	Casing	Wood	A	Intact	Ivory	Bathroom	346	Negative	< LOD
376	Door	Wood	A	Intact	Varnish	Bathroom	346	Negative	< LOD
377	Wall	Gypsum	A	Intact	Ivory	Bathroom	346	Negative	< LOD
378	Wall	Gypsum	B	Intact	Ivory	Bathroom	346	Negative	< LOD
379	Wall	Gypsum	C	Intact	Ivory	Bathroom	346	Negative	< LOD
380	Wall	Gypsum	D	Intact	Ivory	Bathroom	346	Negative	< LOD
381	Ceiling	Gypsum		Intact	Ivory	Bathroom	346	Negative	< LOD
382	Chair Rail	Wood	A	Intact	Ivory	Bathroom	346	Negative	< LOD
383	Casing	Wood	D	Intact	Ivory	Bedroom	346	Negative	< LOD
384	Door	Wood	D	Intact	Ivory	Bedroom	346	Negative	< LOD
385	Wall	Gypsum	A	Intact	Ivory	Bedroom	346	Negative	< LOD
386	Wall	Gypsum	B	Intact	Ivory	Bedroom	346	Negative	< LOD
387	Wall	Gypsum	C	Intact	Ivory	Bedroom	346	Negative	< LOD
388	Wall	Gypsum	D	Intact	Ivory	Bedroom	346	Negative	< LOD
389	Ceiling	Gypsum		Intact	Ivory	Bedroom	346	Negative	< LOD
390	Window Casing	Metal	C	Intact	White	Bedroom	346	Negative	< LOD
391	Window Sash	Metal	C	Intact	White	Bedroom	346	Negative	< LOD
392	Shelf	Metal	A	Intact	Ivory	Bedroom	346	Negative	< LOD
393	Casing	Wood	D	Intact	Ivory	Bedroom	346	Negative	< LOD
394	Door	Wood	D	Intact	Varnish	Bedroom	346	Negative	< LOD
395	Wall	Gypsum	A	Intact	Ivory	Bedroom	346	Negative	< LOD
396	Wall	Gypsum	B	Intact	Ivory	Bedroom	346	Negative	< LOD
397	Wall	Gypsum	C	Intact	Ivory	Bedroom	346	Negative	< LOD
398	Wall	Gypsum	D	Intact	Ivory	Bedroom	346	Negative	< LOD
399	Ceiling	Gypsum		Intact	Ivory	Bedroom	346	Negative	< LOD
400	Casing	Metal	A	Intact	Ivory	Bedroom	346	Negative	< LOD
401	Sash	Metal	A	Intact	Ivory	Bedroom	346	Negative	< LOD
402	Shelf	Metal	C	Intact	Ivory	Bedroom	346	Negative	< LOD
403	Soffet	Metal	A	Intact	White	Exterior	AA-1	Negative	< LOD
404	Facia	Metal	A	Intact	White	Exterior	AA-1	Negative	< LOD
405	Gutter	Metal	A	Intact	White	Exterior	AA-1	Negative	< LOD
406	Trim	Metal	A	Intact	White	Exterior	AA-1	Negative	< LOD
407	Wood Trim	Metal	A	Intact	White	Exterior	AA-1	Negative	0.3
408	Wall	Gypsum	A	Intact	Ivory	Living Room	356	Negative	< LOD
409	Wall	Gypsum	B	Intact	Ivory	Living Room	356	Negative	< LOD
410	Wall	Gypsum	C	Intact	Ivory	Living Room	356	Negative	< LOD

LOD = LIMIT OF DETECTION

PIKE COUNTY HOUSING AUTHORITY  
PITTSFIELD

Reading #	Component	Substrate	Side	Condition	Color	Room	Unit #	Results	PbC
411	Wall	Gypsum	D	Intact	Ivory	Living Room	356	Negative	< LOD
412	Ceiling	Gypsum		Intact	Ivory	Living Room	356	Negative	< LOD
413	Casing	Wood	C	Intact	Ivory	Living Room	356	Negative	< LOD
414	Door	Metal	C	Intact	Ivory	Living Room	356	Negative	< LOD
415	Casing	Metal	B	Intact	Ivory	Living Room	356	Negative	< LOD
416	Door	Metal	B	Intact	White	Living Room	356	Negative	< LOD
417	Wall	Gypsum	A	Intact	Ivory	Kitchen	356	Negative	< LOD
418	Wall	Gypsum	B	Intact	Ivory	Kitchen	356	Negative	< LOD
419	Wall	Gypsum	C	Intact	Ivory	Kitchen	356	Negative	< LOD
420	Wall	Gypsum	D	Intact	Ivory	Kitchen	356	Negative	< LOD
421	Cabinet	Wood	B	Intact	Varnish	Kitchen	356	Negative	< LOD
422	Door	Metal	C	Intact	Ivory	Kitchen	356	Negative	< LOD
423	Jamb	Metal	C	Intact	Ivory	Kitchen	356	Negative	< LOD
424	Casing	Wood	A	Intact	Ivory	Bathroom	356	Negative	< LOD
425	Door	Wood	A	Intact	Varnish	Bathroom	356	Negative	< LOD
426	Wall	Gypsum	A	Intact	Ivory	Bathroom	356	Negative	< LOD
427	Wall	Gypsum	B	Intact	Ivory	Bathroom	356	Negative	< LOD
428	Wall	Gypsum	C	Intact	Ivory	Bathroom	356	Negative	< LOD
429	Wall	Gypsum	D	Intact	Ivory	Bathroom	356	Negative	< LOD
430	Ceiling	Gypsum		Intact	Ivory	Bathroom	356	Negative	< LOD
431	Chair Rail	Wood	A	Intact	Ivory	Bathroom	356	Negative	< LOD
432	Wall	Gypsum	A	Intact	Ivory	Bedroom	356	Negative	< LOD
433	Wall	Gypsum	B	Intact	Ivory	Bedroom	356	Negative	< LOD
434	Wall	Gypsum	C	Intact	Ivory	Bedroom	356	Negative	< LOD
435	Wall	Gypsum	D	Intact	Ivory	Bedroom	356	Negative	< LOD
436	Ceiling	Gypsum		Intact	Ivory	Bedroom	356	Negative	< LOD
437	Shelf	Metal	A	Intact	Ivory	Bedroom	356	Negative	< LOD
438	Window Casing	Metal	C	Intact	White	Bedroom	356	Negative	< LOD
439	Window Sash	Metal	C	Intact	White	Bedroom	356	Negative	< LOD
440	Door	Wood	D	Intact	Varnish	Bedroom	356	Negative	< LOD
441	Casing	Wood	D	Intact	Ivory	Bedroom	356	Negative	< LOD
442	Casing	Wood	D	Intact	Ivory	Bedroom	356	Negative	< LOD
443	Door	Wood	D	Intact	Varnish	Bedroom	356	Negative	< LOD
444	Wall	Gypsum	A	Intact	Ivory	Bedroom	356	Negative	< LOD
445	Wall	Gypsum	D	Intact	Ivory	Bedroom	356	Negative	< LOD
446	Wall	Gypsum	C	Intact	Ivory	Bedroom	356	Negative	< LOD
447	Wall	Gypsum	B	Intact	Ivory	Bedroom	356	Negative	< LOD
448	Ceiling	Gypsum		Intact	Ivory	Bedroom	356	Negative	< LOD
449	Window Casing	Metal	A	Intact	White	Bedroom	356	Negative	< LOD
450	Window Sash	Metal	A	Intact	White	Bedroom	356	Negative	< LOD
451	Shelf	Wood	C	Intact	Ivory	Bedroom	356	Negative	< LOD

LOD = LIMIT OF DETECTION



PIKE COUNTY HOUSING AUTHORITY  
PITTSFIELD

Reading #	Component	Substrate	Side	Condition	Color	Room	Unit #	Results	PbC
452	Soffet	Metal	A	Intact	White	Exterior	AA-1	Negative	< LOD
453	Facia	Metal	A	Intact	White	Exterior	AA-1	Negative	< LOD
454	Gutter	Metal	A	Intact	White	Exterior	AA-1	Negative	< LOD
455	Wood Trim	Wood	A	Intact	White	Exterior	AA-1	Positive	1.1
456	Wall	Gypsum	A	Intact	Ivory	Living / Kitchen	360	Negative	< LOD
457	Wall	Gypsum	B	Intact	Ivory	Living / Kitchen	360	Negative	< LOD
458	Wall	Gypsum	C	Intact	Ivory	Living / Kitchen	360	Negative	< LOD
459	Wall	Gypsum	D	Intact	Ivory	Living / Kitchen	360	Negative	< LOD
460	Ceiling	Gypsum		Intact	Ivory	Living / Kitchen	360	Negative	< LOD
461	Cabinet	Wood	B	Intact	Varnish	Living / Kitchen	360	Negative	< LOD
462	Jamb	Metal	B	Intact	Ivory	Living / Kitchen	360	Negative	< LOD
463	Casing	Wood	B	Intact	Ivory	Living / Kitchen	360	Negative	< LOD
464	Casing	Wood	A	Intact	Ivory	Living / Kitchen	360	Negative	< LOD
465	Jamb	Wood	A	Intact	Ivory	Bedroom	360	Negative	< LOD
466	Door	Wood	A	Intact	Varnish	Bedroom	360	Negative	< LOD
467	Wall	Gypsum	A	Intact	Ivory	Bedroom	360	Negative	< LOD
468	Wall	Gypsum	B	Intact	Ivory	Bedroom	360	Negative	< LOD
469	Ceiling	Gypsum		Intact	Ivory	Bedroom	360	Negative	< LOD
470	Door	Wood	D	Intact	Varnish	Bathroom	360	Negative	< LOD
471	Casing	Wood	D	Intact	Ivory	Bathroom	360	Negative	< LOD
472	Wall	Gypsum	A	Intact	Ivory	Bathroom	360	Negative	< LOD
473	Wall	Gypsum	B	Intact	Ivory	Bathroom	360	Negative	< LOD
474	Wall	Gypsum	C	Intact	Ivory	Bathroom	360	Negative	< LOD
475	Wall	Gypsum	D	Intact	Ivory	Bathroom	360	Negative	< LOD
476	Ceiling	Gypsum		Intact	Ivory	Bathroom	360	Negative	< LOD
477	Stop	Metal	C	Intact	Ivory	Bathroom	360	Negative	< LOD
478	Window Casing	Metal	A	Intact	White	Living / Kitchen	360	Negative	< LOD
479	Window Sash	Metal	A	Intact	White	Living / Kitchen	360	Negative	< LOD
480	Soffet	Metal	A	Intact	White	Exterior	AA-1	Negative	< LOD
481	W Trim	Metal	A	Intact	White	Exterior	AA-1	Negative	< LOD
482	Gutter	Metal	A	Intact	White	Exterior	AA-1	Negative	< LOD
483	Facia	Metal	A	Intact	White	Exterior	AA-1	Negative	< LOD
484	Wall	Gypsum	A	Intact	Ivory	Living / Kitchen	364	Negative	< LOD
485	Wall	Gypsum	B	Intact	Ivory	Living / Kitchen	364	Negative	< LOD
486	Wall	Gypsum	C	Intact	Ivory	Living / Kitchen	364	Negative	< LOD
487	Wall	Gypsum	D	Intact	Ivory	Living / Kitchen	364	Negative	< LOD
488	Ceiling	Gypsum		Intact	Ivory	Living / Kitchen	364	Negative	< LOD
489	Jamb	Metal	B	Intact	Ivory	Living / Kitchen	364	Negative	< LOD
490	Door	Metal	B	Intact	Ivory	Living / Kitchen	364	Negative	< LOD
491	Cabinet	Wood	B	Intact	Ivory	Living / Kitchen	364	Negative	< LOD
492	Stop	Metal	C	Intact	Ivory	Living / Kitchen	364	Negative	< LOD

LOD = LIMIT OF DETECTION



PIKE COUNTY HOUSING AUTHORITY  
PITTSFIELD

Reading #	Component	Substrate	Side	Condition	Color	Room	Unit #	Results	PbC
493	Shelf	Metal	C	Intact	Ivory	Living / Kitchen	364	Negative	< LOD
494	Casing	Wood	A	Intact	Ivory	Living / Kitchen	364	Negative	< LOD
495	Window Casing	Metal	A	Intact	White	Living / Kitchen	364	Negative	< LOD
496	Window Sash	Metal	A	Intact	White	Living / Kitchen	364	Negative	< LOD
497	Jamb		D	Intact	Ivory	Bedroom	364	Negative	< LOD
498	Door		D	Intact	Ivory	Bedroom	364	Negative	< LOD
499	Wall	Gypsum	A	Intact	Ivory	Bedroom	364	Negative	< LOD
500	Wall	Gypsum	B	Intact	Ivory	Bedroom	364	Negative	< LOD
501	Wall	Gypsum	C	Intact	Ivory	Bedroom	364	Negative	< LOD
502	Wall	Gypsum	D	Intact	Ivory	Bedroom	364	Negative	< LOD
503	Ceiling	Gypsum		Intact	Ivory	Bedroom	364	Negative	< LOD
504	Jamb	Wood	D	Intact	Ivory	Bathroom	364	Negative	< LOD
505	Door	Wood	D	Intact	Ivory	Bathroom	364	Negative	< LOD
506	Wall	Gypsum	A	Intact	Ivory	Bathroom	364	Negative	< LOD
507	Wall	Gypsum	B	Intact	Ivory	Bathroom	364	Negative	< LOD
508	Wall	Gypsum	C	Intact	Ivory	Bathroom	364	Negative	< LOD
509	Wall	Gypsum	D	Intact	Ivory	Bathroom	364	Negative	< LOD
510	Ceiling	Gypsum		Intact	Ivory	Bathroom	364	Negative	< LOD
511	Wall	Gypsum	A	Intact	Ivory	Living / Kitchen	366	Negative	< LOD
512	Wall	Gypsum	B	Intact	Ivory	Living / Kitchen	366	Negative	< LOD
513	Wall	Gypsum	C	Intact	Ivory	Living / Kitchen	366	Negative	< LOD
514	Wall	Gypsum	D	Intact	Ivory	Living / Kitchen	366	Negative	< LOD
515	Ceiling	Gypsum		Intact	Ivory	Living / Kitchen	366	Negative	< LOD
516	Window Casing	Metal	A	Intact	White	Living / Kitchen	366	Negative	< LOD
517	Window Sash	Metal	A	Intact	White	Living / Kitchen	366	Negative	< LOD
518	Door	Metal	D	Intact	Ivory	Living / Kitchen	366	Negative	< LOD
519	Jamb	Metal	D	Intact	Ivory	Living / Kitchen	366	Negative	< LOD
520	Cabinet	Wood	D	Intact	Varnish	Living / Kitchen	366	Negative	< LOD
521	Stop	Metal	C	Intact	Ivory	Living / Kitchen	366	Negative	< LOD
522	Shelf	Metal	C	Intact	Ivory	Living / Kitchen	366	Negative	< LOD
523	Casing	Wood	A	Intact	Ivory	Living / Kitchen	366	Negative	< LOD
524	Door	Wood	A	Intact	Varnish	Bedroom	366	Negative	< LOD
525	Jamb	Wood	A	Intact	Ivory	Bedroom	366	Negative	< LOD
526	Wall	Gypsum	A	Intact	Ivory	Bedroom	366	Negative	< LOD
527	Wall	Gypsum	B	Intact	Ivory	Bedroom	366	Negative	< LOD
528	Wall	Gypsum	C	Intact	Ivory	Bedroom	366	Negative	0.09
529	Wall	Gypsum	D	Intact	Ivory	Bedroom	366	Negative	0.07
530	Ceiling	Gypsum		Intact	Ivory	Bedroom	366	Negative	< LOD
531	Door	Wood	B	Intact	Varnish	Bathroom	366	Negative	< LOD
532	Jamb	Wood	B	Intact	Ivory	Bathroom	366	Negative	< LOD
533	Wall	Gypsum	A	Intact	Ivory	Bathroom	366	Negative	< LOD

LOD = LIMIT OF DETECTION

PIKE COUNTY HOUSING AUTHORITY  
PITTSFIELD

Reading #	Component	Substrate	Side	Condition	Color	Room	Unit #	Results	PbC
534	Wall	Gypsum	B	Intact	Ivory	Bathroom	366	Negative	< LOD
535	Wall	Gypsum	C	Intact	Ivory	Bathroom	366	Negative	< LOD
536	Wall	Gypsum	D	Intact	Ivory	Bathroom	366	Negative	< LOD
537	Ceiling	Gypsum		Intact	Ivory	Bathroom	366	Negative	< LOD
538	Soffet	Metal	A	Intact	White	Exterior	AA-1	Negative	< LOD
539	Trim	Metal	A	Intact	White	Exterior	AA-1	Negative	< LOD
540	Facia	Metal	A	Intact	White	Exterior	AA-1	Negative	< LOD
541	Gutter	Metal	A	Intact	White	Exterior	AA-1	Negative	< LOD
542	Wood Trim	Wood	A	Intact	White	Exterior	AA-1	Negative	0.5
<b>543</b>	<b>Wood Trim</b>	<b>Wood</b>	<b>A</b>	<b>Intact</b>	<b>White</b>	<b>Exterior</b>	<b>AA-1</b>	<b>Positive</b>	<b>1</b>
544	Wall	Gypsum	A	Intact	Ivory	Living / Kitchen	372	Negative	< LOD
545	Wall	Gypsum	B	Intact	Ivory	Living / Kitchen	372	Negative	< LOD
546	Wall	Gypsum	C	Intact	Ivory	Living / Kitchen	372	Negative	< LOD
547	Wall	Gypsum	D	Intact	Ivory	Living / Kitchen	372	Negative	< LOD
548	Ceiling	Gypsum		Intact	Ivory	Living / Kitchen	372	Negative	< LOD
549	Jamb	Metal	B	Intact	Ivory	Living / Kitchen	372	Negative	< LOD
550	Door	Metal	B	Intact	Ivory	Living / Kitchen	372	Negative	< LOD
551	Cabinet	Wood	B	Intact	Varnish	Living / Kitchen	372	Negative	< LOD
552	Stop	Metal	C	Intact	Ivory	Living / Kitchen	372	Negative	< LOD
553	Shelf	Metal	C	Intact	Ivory	Living / Kitchen	372	Negative	< LOD
554	Casing	Wood	A	Intact	Ivory	Living / Kitchen	372	Negative	< LOD
555	Casing	Wood	A	Intact	Ivory	Bedroom	372	Negative	< LOD
556	Door	Wood	A	Intact	Varnish	Bedroom	372	Negative	< LOD
557	Wall	Gypsum	A	Intact	Ivory	Bedroom	372	Negative	< LOD
558	Wall	Gypsum	B	Intact	Ivory	Bedroom	372	Negative	< LOD
559	Wall	Gypsum	C	Intact	Ivory	Bedroom	372	Negative	< LOD
560	Wall	Gypsum	D	Intact	Ivory	Bedroom	372	Negative	0.05
561	Ceiling	Gypsum		Intact	Ivory	Bedroom	372	Negative	< LOD
562	Stop	Metal	A	Intact	Ivory	Bedroom	372	Negative	< LOD
563	Shelf	Metal	A	Intact	Ivory	Bedroom	372	Negative	< LOD
564	Window Casing	Metal	C	Intact	White	Bedroom	372	Negative	< LOD
565	Window Sash	Metal	C	Intact	White	Bedroom	372	Negative	< LOD
566	Door		D	Intact	Varnish	Bathroom	372	Negative	< LOD
567	Casing		D	Intact	Ivory	Bathroom	372	Negative	< LOD
568	Wall	Gypsum	A	Intact	Ivory	Bathroom	372	Negative	< LOD
569	Wall	Gypsum	B	Intact	Ivory	Bathroom	372	Negative	< LOD
570	Wall	Gypsum	C	Intact	Ivory	Bathroom	372	Negative	< LOD
571	Wall	Gypsum	D	Intact	Ivory	Bathroom	372	Negative	< LOD
572	Ceiling	Gypsum		Intact	Ivory	Bathroom	372	Negative	< LOD
573	Calibrate								1
574	Calibrate								0.9
575	Calibrate								1

LOD = LIMIT OF DETECTION

PIKE COUNTY HOUSING AUTHORITY  
PITTSFIELD

Reading #	Component	Substrate	Side	Condition	Color	Room	Unit #	Results	PbC
1	Self Calibrate								5.71
2	Calibrate								1
3	Calibrate								1.1
4	Calibrate								1
5	Wall	Gypsum	A	Intact	Ivory	Liv./Kitch.	313	Negative	< LOD
6	Wall	Gypsum	B	Intact	Ivory	Liv./Kitch.	313	Negative	< LOD
7	Wall	Gypsum	C	Intact	Ivory	Liv./Kitch.	313	Negative	< LOD
8	Wall	Gypsum	D	Intact	Ivory	Liv./Kitch.	313	Negative	< LOD
9	Ceiling	Gypsum		Intact	Ivory	Liv./Kitch.	313	Negative	< LOD
10	Jamb	Metal	B	Intact	Ivory	Liv./Kitch.	313	Negative	< LOD
11	Door	Metal	B	Intact	Ivory	Liv./Kitch.	313	Negative	< LOD
12	Window Casing	Metal	A	Intact	White	Liv./Kitch.	313	Negative	< LOD
13	Window Sash	Metal	A	Intact	White	Liv./Kitch.	313	Negative	< LOD
14	Cabinet	Wood	B	Intact	Varnish	Liv./Kitch.	313	Negative	< LOD
15	Door Stop	Metal	B	Intact	Ivory	Liv./Kitch.	313	Negative	< LOD
16	Door Casing	Wood	A	Intact	Ivory	Liv./Kitch.	313	Negative	< LOD
17	Door	Metal	D	Intact	Ivory	Liv./Kitch.	313	Negative	< LOD
18	Door Casing	Wood	A	Intact	Ivory	Bedroom	313	Negative	< LOD
19	Door	Wood	A	Intact	Ivory	Bedroom	313	Negative	< LOD
20	Wall	Gypsum	A	Intact	Ivory	Bedroom	313	Negative	< LOD
21	Wall	Gypsum	B	Intact	Ivory	Bedroom	313	Negative	< LOD
22	Wall	Gypsum	C	Intact	Ivory	Bedroom	313	Negative	< LOD
23	Wall	Gypsum	D	Intact	Ivory	Bedroom	313	Negative	< LOD
24	Ceiling	Gypsum		Intact	Ivory	Bedroom	313	Negative	< LOD
25	Door Stop	Metal	A	Intact	Ivory	Bedroom	313	Negative	< LOD
26	Window Casing	Metal	C	Intact	White	Bedroom	313	Negative	< LOD
27	Window Sash	Metal	C	Intact	White	Bedroom	313	Negative	< LOD
28	Door	Wood	A	Intact	Ivory	Bathroom	313	Negative	< LOD
29	Door Casing	Wood	A	Intact	Ivory	Bathroom	313	Negative	< LOD
30	Wall	Gypsum	A	Intact	Ivory	Bathroom	313	Negative	< LOD
31	Wall	Gypsum	B	Intact	Ivory	Bathroom	313	Negative	< LOD
32	Wall	Gypsum	C	Intact	Ivory	Bathroom	313	Negative	< LOD
33	Wall	Gypsum	D	Intact	Ivory	Bathroom	313	Negative	< LOD
34	Ceiling	Gypsum		Intact	Ivory	Bathroom	313	Negative	< LOD
35	Wall	Gypsum	C	Intact	Ivory	Liv./Kitch.	315	Negative	< LOD
36	Wall	Gypsum	B	Intact	Ivory	Liv./Kitch.	315	Negative	< LOD
37	Wall	Gypsum	A	Intact	Ivory	Liv./Kitch.	315	Negative	< LOD
38	Wall	Gypsum	D	Intact	Ivory	Liv./Kitch.	315	Negative	< LOD
39	Ceiling	Gypsum		Intact	Ivory	Liv./Kitch.	315	Negative	< LOD
40	Cabinet	Wood	D	Intact	Ivory	Liv./Kitch.	315	Negative	< LOD
41	Door Stop	Metal	C	Intact	Ivory	Liv./Kitch.	315	Negative	< LOD

LOD = LIMIT OF DETECTION

PIKE COUNTY HOUSING AUTHORITY  
PITTSFIELD

Reading #	Component	Substrate	Side	Condition	Color	Room	Unit #	Results	PbC
42	Door	Wood	A	Intact	Ivory	Bedroom	315	Negative	< LOD
43	Door Casing	Wood	A	Intact	Ivory	Bedroom	315	Negative	< LOD
44	Wall	Gypsum	A	Intact	Ivory	Bedroom	315	Negative	< LOD
45	Wall	Gypsum	B	Intact	Ivory	Bedroom	315	Negative	< LOD
46	Wall	Gypsum	C	Intact	Ivory	Bedroom	315	Negative	< LOD
47	Wall	Gypsum	D	Intact	Ivory	Bedroom	315	Negative	< LOD
48	Ceiling	Gypsum		Intact	Ivory	Bedroom	315	Negative	< LOD
49	Window Casing	Metal	B	Intact	White	Bedroom	315	Negative	< LOD
50	Window Sash	Metal	B	Intact	White	Bedroom	315	Negative	< LOD
51	Door Stop	Metal	A	Intact	Ivory	Bedroom	315	Negative	< LOD
52	Shelf	Metal	A	Intact	Ivory	Bedroom	315	Negative	< LOD
53	Door	Wood	B	Intact	Varnish	Bathroom	315	Negative	< LOD
54	Jamb	Wood	B	Intact	Ivory	Bathroom	315	Negative	< LOD
55	Wall	Gypsum	A	Intact	Ivory	Bathroom	315	Negative	< LOD
56	Wall	Gypsum	B	Intact	Ivory	Bathroom	315	Negative	< LOD
57	Wall	Gypsum	C	Intact	Ivory	Bathroom	315	Negative	< LOD
58	Wall	Gypsum	D	Intact	Ivory	Bathroom	315	Negative	< LOD
59	Ceiling	Gypsum		Intact	Ivory	Bathroom	315	Negative	< LOD
60	Window Casing	Wood	A	Intact	White	Exterior	BB-1	Negative	0.5
61	Soffet	Metal	A	Intact	White	Exterior	BB-1	Negative	< LOD
62	Facia	Metal	A	Intact	White	Exterior	BB-1	Negative	< LOD
<b>63</b>	<b>Trim</b>	<b>Wood</b>	<b>A</b>	<b>Peeling</b>	<b>White</b>	<b>Exterior</b>	<b>BB-1</b>	<b>Positive</b>	<b>1.1</b>
64	Down Spout	Metal	A	Intact	White	Exterior	BB-1	Negative	< LOD
65	Wall	Gypsum	A	Intact	Ivory	Liv./Kitch.	337	Negative	< LOD
66	Wall	Gypsum	B	Intact	Ivory	Liv./Kitch.	337	Negative	< LOD
67	Wall	Gypsum	C	Intact	Ivory	Liv./Kitch.	337	Negative	< LOD
68	Wall	Gypsum	D	Intact	Ivory	Liv./Kitch.	337	Negative	< LOD
69	Ceiling	Gypsum		Intact	Ivory	Liv./Kitch.	337	Negative	< LOD
70	Cabnet	Wood	B	Intact	Ivory	Liv./Kitch.	337	Negative	< LOD
71	Door Stop	Metal	A	Intact	Ivory	Liv./Kitch.	337	Negative	< LOD
72	Shelf	Metal	A	Intact	Ivory	Liv./Kitch.	337	Negative	< LOD
73	Door Casing	Metal	B	Intact	Ivory	Liv./Kitch.	337	Negative	< LOD
74	Door	Metal	B	Intact	Ivory	Liv./Kitch.	337	Negative	< LOD
75	Window Casing	Metal	A	Intact	White	Liv./Kitch.	337	Negative	< LOD
76	Window Sash	Metal	A	Intact	White	Liv./Kitch.	337	Negative	< LOD
77	Door	Metal	C	Intact	Ivory	Liv./Kitch.	337	Negative	< LOD
78	Door	Wood	A	Intact	Varnish	Bedroom	337	Negative	< LOD
79	Jamb	Wood	A	Intact	Ivory	Bedroom	337	Negative	< LOD
80	Wall	Gypsum	A	Intact	Ivory	Bedroom	337	Negative	< LOD
81	Wall	Gypsum	B	Intact	Ivory	Bedroom	337	Negative	< LOD
82	Wall	Gypsum	C	Intact	Ivory	Bedroom	337	Negative	< LOD

LOD = LIMIT OF DETECTION



PIKE COUNTY HOUSING AUTHORITY

PITTSFIELD

Reading #	Component	Substrate	Side	Condition	Color	Room	Unit #	Results	PbC
83	Wall	Gypsum	D	Intact	Ivory	Bedroom	337	Negative	< LOD
84	Ceiling	Gypsum		Intact	Ivory	Bedroom	337	Negative	< LOD
85	Door Stop	Metal	A	Intact	Ivory	Bedroom	337	Negative	< LOD
86	Shelf	Metal	A	Intact	Ivory	Bedroom	337	Negative	< LOD
87	Window Casing	Metal	C	Intact	White	Bedroom	337	Negative	< LOD
88	Window Sash	Metal	C	Intact	White	Bedroom	337	Negative	< LOD
89	Door	Wood	D	Intact	Varnish	Bathroom	337	Negative	< LOD
90	Jamb	Wood	D	Intact	Ivory	Bathroom	337	Negative	< LOD
91	Wall	Gypsum	A	Intact	Ivory	Bathroom	337	Negative	< LOD
92	Wall	Gypsum	B	Intact	Ivory	Bathroom	337	Negative	< LOD
93	Wall	Gypsum	C	Intact	Ivory	Bathroom	337	Negative	< LOD
94	Wall	Gypsum	D	Intact	Ivory	Bathroom	337	Negative	< LOD
95	Ceiling	Gypsum		Intact	Ivory	Bathroom	337	Negative	< LOD
96	Soffet	Metal	A	Intact	White	Exterior	AA-1	Negative	< LOD
97	Gutter	Metal	A	Intact	White	Exterior	AA-1	Negative	< LOD
98	Facia	Metal	A	Intact	White	Exterior	AA-1	Negative	< LOD
99	Trim	Wood	A	Intact	White	Exterior	AA-1	Negative	< LOD
<b>100</b>	<b>Trim</b>	<b>Wood</b>	<b>A</b>	<b>Peeling</b>	<b>White</b>	<b>Exterior</b>	<b>AA-1</b>	<b>Positive</b>	<b>1.2</b>
101	Hand Rail	Metal	A	Chipped	Gray	Exterior	AA-1	Negative	< LOD
102	Stripe	Concrete	A	Chipped	Yellow	Exterior	AA-1	Negative	< LOD
103	Wall	Gypsum	A	Intact	Ivory	Liv./Kitch.	349	Negative	< LOD
104	Wall	Gypsum	B	Intact	Ivory	Liv./Kitch.	349	Negative	< LOD
105	Wall	Gypsum	C	Intact	Ivory	Liv./Kitch.	349	Negative	< LOD
106	Wall	Gypsum	D	Intact	Ivory	Liv./Kitch.	349	Negative	< LOD
107	Ceiling	Gypsum		Intact	Ivory	Liv./Kitch.	349	Negative	< LOD
108	Door Stop	Metal	C	Intact	Ivory	Liv./Kitch.	349	Negative	< LOD
109	Shelf	Metal	C	Intact	Ivory	Liv./Kitch.	349	Negative	< LOD
110	Cabinet	Wood	B	Intact	Varnish	Liv./Kitch.	349	Negative	< LOD
111	Window Casing	Wood	A	Intact	Ivory	Liv./Kitch.	349	Negative	< LOD
112	Door Casing	Wood	B	Intact	Ivory	Liv./Kitch.	349	Negative	< LOD
113	Door	Wood	B	Intact	Ivory	Liv./Kitch.	349	Negative	< LOD
114	Window Casing	Wood	D	Intact	White	Liv./Kitch.	349	Negative	< LOD
115	Window Sash	Wood	D	Intact	White	Liv./Kitch.	349	Negative	< LOD
116	Door	Metal	C	Intact	White	Liv./Kitch.	349	Negative	< LOD
117	Door	Wood	A	Intact	Varnish	Bedroom	349	Negative	< LOD
118	Jamb	Wood	A	Intact	Ivory	Bedroom	349	Negative	< LOD
119	Wall	Gypsum	A	Intact	Ivory	Bedroom	349	Negative	< LOD
120	Wall	Gypsum	B	Intact	Ivory	Bedroom	349	Negative	< LOD
121	Wall	Gypsum	C	Intact	Ivory	Bedroom	349	Negative	< LOD
122	Wall	Gypsum	D	Intact	Ivory	Bedroom	349	Negative	< LOD
123	Ceiling	Gypsum		Intact	Ivory	Bedroom	349	Negative	< LOD

LOD = LIMIT OF DETECTION



PIKE COUNTY HOUSING AUTHORITY  
PITTSFIELD

Reading #	Component	Substrate	Side	Condition	Color	Room	Unit #	Results	PbC
124	Window Casing	Metal	C	Intact	White	Bedroom	349	Negative	< LOD
125	Window Sash	Metal	C	Intact	White	Bedroom	349	Negative	< LOD
126	Door Stop	Metal	A	Intact	Ivory	Bedroom	349	Negative	< LOD
127	Support	Wood	A	Intact	Ivory	Bedroom	349	Negative	< LOD
129	Jamb	Wood	D	Intact	Ivory	Bathroom	349	Negative	< LOD
130	Wall	Gypsum	A	Intact	Ivory	Bathroom	349	Negative	< LOD
131	Wall	Gypsum	B	Intact	Ivory	Bathroom	349	Negative	< LOD
132	Wall	Gypsum	C	Intact	Ivory	Bathroom	349	Negative	< LOD
133	Wall	Gypsum	D	Intact	Ivory	Bathroom	349	Negative	< LOD
134	Ceiling	Gypsum		Intact	Ivory	Bathroom	349	Negative	< LOD
135	Void			Intact	Ivory	Bathroom	349	Negative	< LOD
136	Wall	Gypsum	A	Intact	Ivory	Liv./Kitch.	355	Negative	< LOD
137	Wall	Gypsum	B	Intact	Ivory	Liv./Kitch.	355	Negative	< LOD
138	Wall	Gypsum	C	Intact	Ivory	Liv./Kitch.	355	Negative	< LOD
139	Wall	Gypsum	D	Intact	Ivory	Liv./Kitch.	355	Negative	< LOD
140	Ceiling	Gypsum		Intact	Ivory	Liv./Kitch.	355	Negative	< LOD
141	Cabinet	Wood	D	Intact	Varnish	Liv./Kitch.	355	Negative	< LOD
142	Door Stop	Metal	C	Intact	Ivory	Liv./Kitch.	355	Negative	< LOD
143	Shelf	Metal	C	Intact	Ivory	Liv./Kitch.	355	Negative	< LOD
144	Window Casing	Wood	A	Intact	Ivory	Liv./Kitch.	355	Negative	< LOD
145	Door Casing	Metal	D	Intact	Ivory	Liv./Kitch.	355	Negative	< LOD
146	Door	Metal	D	Intact	Ivory	Liv./Kitch.	355	Negative	< LOD
147	Window Casing	Metal	B	Intact	White	Liv./Kitch.	355	Negative	< LOD
148	Window Sash	Metal	B	Intact	White	Liv./Kitch.	355	Negative	< LOD
149	Door	Wood	A	Intact	Varnish	Bedroom	355	Negative	< LOD
150	Jamb	Wood	A	Intact	Ivory	Bedroom	355	Negative	< LOD
151	Wall	Gypsum	A	Intact	Ivory	Bedroom	355	Negative	< LOD
152	Wall	Gypsum	B	Intact	Ivory	Bedroom	355	Negative	< LOD
153	Wall	Gypsum	C	Intact	Ivory	Bedroom	355	Negative	< LOD
154	Wall	Gypsum	D	Intact	Ivory	Bedroom	355	Negative	< LOD
155	Ceiling	Gypsum		Intact	Ivory	Bedroom	355	Negative	< LOD
156	Door Stop	Metal	A	Intact	Ivory	Bedroom	355	Negative	< LOD
157	Shelf	Metal	A	Intact	Ivory	Bedroom	355	Negative	< LOD
158	Window Casing	Metal	B	Intact	White	Bedroom	355	Negative	< LOD
159	Window Sash	Metal	B	Intact	White	Bedroom	355	Negative	< LOD
160	Door	Wood	B	Intact	Varnish	Bathroom	355	Negative	< LOD
161	Jamb	Wood	B	Intact	Ivory	Bathroom	355	Negative	< LOD
162	Wall	Gypsum	A	Intact	Ivory	Bathroom	355	Negative	< LOD
163	Wall	Gypsum	B	Intact	Ivory	Bathroom	355	Negative	< LOD
164	Wall	Gypsum	C	Intact	Ivory	Bathroom	355	Negative	< LOD
165	Wall	Gypsum	D	Intact	Ivory	Bathroom	355	Negative	< LOD

LOD = LIMIT OF DETECTION

PIKE COUNTY HOUSING AUTHORITY  
PITTSFIELD

Reading #	Component	Substrate	Side	Condition	Color	Room	Unit #	Results	PbC
166	Ceiling	Gypsum		Intact	Ivory	Bathroom	355	Negative	< LOD
167	Soffet	Metal	A	Intact	White	Exterior	AA-1	Negative	< LOD
168	Facia	Metal	A	Intact	White	Exterior	AA-1	Negative	< LOD
169	Gutter	Metal	A	Intact	White	Exterior	AA-1	Negative	< LOD
<b>170</b>	<b>Trim</b>	<b>Wood</b>	<b>A</b>	<b>Peeling</b>	<b>White</b>	<b>Exterior</b>	<b>AA-1</b>	<b>Positive</b>	<b>1</b>
171	Window Casing	Wood	A	Intact	White	Exterior	AA-1	Negative	< LOD
172	Wall	Gypsum	A	Intact	Ivory	Liv./Kitch.	357	Negative	< LOD
173	Wall	Gypsum	B	Intact	Ivory	Liv./Kitch.	357	Negative	< LOD
174	Wall	Gypsum	C	Intact	Ivory	Liv./Kitch.	357	Negative	< LOD
175	Wall	Gypsum	D	Intact	Ivory	Liv./Kitch.	357	Negative	< LOD
176	Ceiling	Gypsum		Intact	Ivory	Liv./Kitch.	357	Negative	< LOD
177	Cabinet	Wood	B	Intact	Varnish	Liv./Kitch.	357	Negative	< LOD
178	Door Stop	Metal	C	Intact	Ivory	Liv./Kitch.	357	Negative	< LOD
179	Shelf	Metal	C	Intact	Ivory	Liv./Kitch.	357	Negative	< LOD
180	Jamb	Metal	B	Intact	Ivory	Liv./Kitch.	357	Negative	< LOD
181	Door	Metal	D	Intact	Ivory	Liv./Kitch.	357	Negative	< LOD
182	Window Casing	Metal	D	Intact	Ivory	Liv./Kitch.	357	Negative	< LOD
183	Window Sash	Metal	D	Intact	Ivory	Liv./Kitch.	357	Negative	< LOD
184	Door Stop	Metal	D	Intact	Ivory	Liv./Kitch.	357	Negative	< LOD
185	Jamb	Wood	A	Intact	Ivory	Bedroom	357	Negative	< LOD
186	Door	Wood	A	Intact	Ivory	Bedroom	357	Negative	< LOD
187	Wall	Gypsum	A	Intact	Ivory	Bedroom	357	Negative	< LOD
188	Wall	Gypsum	B	Intact	Ivory	Bedroom	357	Negative	< LOD
189	Wall	Gypsum	C	Intact	Ivory	Bedroom	357	Negative	< LOD
190	Wall	Gypsum	D	Intact	Ivory	Bedroom	357	Negative	< LOD
191	Ceiling	Gypsum		Intact	Ivory	Bedroom	357	Negative	< LOD
192	Door Stop	Metal	A	Intact	Ivory	Bedroom	357	Negative	< LOD
193	Shelf	Metal	A	Intact	Ivory	Bedroom	357	Negative	< LOD
194	Window Casing	Metal	C	Intact	White	Bedroom	357	Negative	< LOD
195	Window Sash	Metal	C	Intact	White	Bedroom	357	Negative	< LOD
196	Door	Wood	D	Intact	Varnish	Bathroom	357	Negative	< LOD
197	Jamb	Wood	D	Intact	Ivory	Bathroom	357	Negative	< LOD
198	Wall	Gypsum	A	Intact	Ivory	Bathroom	357	Negative	< LOD
199	Wall	Gypsum	B	Intact	Ivory	Bathroom	357	Negative	< LOD
200	Wall	Gypsum	C	Intact	Ivory	Bathroom	357	Negative	< LOD
201	Wall	Gypsum	D	Intact	Ivory	Bathroom	357	Negative	< LOD
202	Ceiling	Gypsum		Intact	Ivory	Bathroom	357	Negative	< LOD
203	Soffet	Metal	A	Intact	White	Exterior	BB-1	Negative	< LOD
204	Facia	Metal	A	Intact	White	Exterior	BB-1	Negative	< LOD
205	Gutter	Metal	A	Intact	White	Exterior	BB-1	Negative	< LOD
206	Trim	Wood	A	Intact	White	Exterior	BB-1	Negative	< LOD

LOD = LIMIT OF DETECTION

PIKE COUNTY HOUSING AUTHORITY  
PITTSFIELD

Reading #	Component	Substrate	Side	Condition	Color	Room	Unit #	Results	PbC
207	Trim	Wood	A	Peeling	White	Exterior	BB-1	Positive	1
208	Wall	Gypsum	A	Intact	Ivory	Liv./Kitch.	361	Negative	< LOD
209	Wall	Gypsum	B	Intact	Ivory	Liv./Kitch.	361	Negative	< LOD
210	Wall	Gypsum	C	Intact	Ivory	Liv./Kitch.	361	Negative	< LOD
211	Wall	Gypsum	D	Intact	Ivory	Liv./Kitch.	361	Negative	< LOD
212	Ceiling	Gypsum		Intact	Ivory	Liv./Kitch.	361	Negative	< LOD
213	Door Stop	Metal	C	Intact	Ivory	Liv./Kitch.	361	Negative	< LOD
214	Window Casing	Wood	A	Intact	Ivory	Liv./Kitch.	361	Negative	< LOD
215	Cabinet	Wood	B	Intact	Varnish	Liv./Kitch.	361	Negative	< LOD
216	Jamb	Metal	B	Intact	Ivory	Liv./Kitch.	361	Negative	< LOD
217	Door	Metal	B	Intact	Ivory	Liv./Kitch.	361	Negative	< LOD
218	Window Casing	Metal	A	Intact	White	Liv./Kitch.	361	Negative	< LOD
219	Window Sash	Metal	A	Intact	White	Liv./Kitch.	361	Negative	< LOD
220	Door	Wood	A	Intact	Varnish	Bedroom	361	Negative	< LOD
221	Jamb	Wood	A	Intact	Ivory	Bedroom	361	Negative	< LOD
222	Wall	Gypsum	A	Intact	Ivory	Bedroom	361	Negative	< LOD
223	Wall	Gypsum	B	Intact	Ivory	Bedroom	361	Negative	< LOD
224	Wall	Gypsum	C	Intact	Ivory	Bedroom	361	Negative	< LOD
225	Wall	Gypsum	D	Intact	Ivory	Bedroom	361	Negative	< LOD
226	Ceiling	Gypsum		Intact	Ivory	Bedroom	361	Negative	< LOD
227	Door Stop	Metal	A	Intact	Ivory	Bedroom	361	Negative	< LOD
228	Shelf	Metal	A	Intact	Ivory	Bedroom	361	Negative	< LOD
229	Window Casing	Metal	C	Intact	Ivory	Bedroom	361	Negative	< LOD
230	Window Sash	Metal	C	Intact	Ivory	Bedroom	361	Negative	< LOD
231	Door	Wood	D	Intact	Varnish	Bathroom	361	Negative	< LOD
232	Jamb	Wood	D	Intact	Ivory	Bathroom	361	Negative	< LOD
233	Wall	Gypsum	A	Intact	Ivory	Bathroom	361	Negative	< LOD
234	Wall	Gypsum	B	Intact	Ivory	Bathroom	361	Negative	< LOD
235	Wall	Gypsum	C	Intact	Ivory	Bathroom	361	Negative	< LOD
236	Wall	Gypsum	D	Intact	Ivory	Bathroom	361	Negative	< LOD
237	Ceiling	Gypsum		Intact	Ivory	Bathroom	361	Negative	< LOD
238	Wall	Gypsum	A	Intact	Ivory	Liv./Kitch.	369	Negative	< LOD
239	Wall	Gypsum	D	Intact	Ivory	Liv./Kitch.	369	Negative	< LOD
240	Wall	Gypsum	C	Intact	Ivory	Liv./Kitch.	369	Negative	< LOD
241	Wall	Gypsum	B	Intact	Ivory	Liv./Kitch.	369	Negative	< LOD
242	Ceiling	Gypsum		Intact	Ivory	Liv./Kitch.	369	Negative	< LOD
243	Door Stop	Metal	C	Intact	Ivory	Liv./Kitch.	369	Negative	< LOD
244	Shelf	Metal	C	Intact	Ivory	Liv./Kitch.	369	Negative	< LOD
245	Cabinet	Wood	B	Intact	Varnish	Liv./Kitch.	369	Negative	< LOD
246	Window Casing	Wood	A	Intact	Ivory	Liv./Kitch.	369	Negative	< LOD
247	Jamb	Metal	B	Intact	Ivory	Liv./Kitch.	369	Negative	< LOD

LOD = LIMIT OF DETECTION

PIKE COUNTY HOUSING AUTHORITY  
PITTSFIELD

Reading #	Component	Substrate	Side	Condition	Color	Room	Unit #	Results	PbC
248	Door	Metal	B	Intact	White	Liv./Kitch.	369	Negative	< LOD
249	Window Casing	Metal	A	Intact	White	Liv./Kitch.	369	Negative	< LOD
250	Window Sash	Metal	A	Intact	White	Liv./Kitch.	369	Negative	< LOD
251	Door	Wood	A	Intact	Varnish	Bedroom	369	Negative	< LOD
252	Jamb	Wood	A	Intact	Ivory	Bedroom	369	Negative	< LOD
253	Wall	Gypsum	A	Intact	Ivory	Bedroom	369	Negative	< LOD
254	Wall	Gypsum	B	Intact	Ivory	Bedroom	369	Negative	< LOD
255	Wall	Gypsum	C	Intact	Ivory	Bedroom	369	Negative	< LOD
256	Wall	Gypsum	D	Intact	Ivory	Bedroom	369	Negative	< LOD
257	Ceiling	Gypsum		Intact	Ivory	Bedroom	369	Negative	< LOD
258	Door Stop	Metal	A	Intact	Ivory	Bedroom	369	Negative	< LOD
259	Shelf	Metal	A	Intact	Ivory	Bedroom	369	Negative	< LOD
260	Window Casing	Metal	C	Intact	White	Bedroom	369	Negative	< LOD
261	Window Sash	Metal	C	Intact	White	Bedroom	369	Negative	< LOD
262	Door	Wood	D	Intact	Varnish	Bathroom	369	Negative	< LOD
263	Jamb	Wood	D	Intact	Ivory	Bathroom	369	Negative	< LOD
264	Wall	Gypsum	A	Intact	Ivory	Bathroom	369	Negative	< LOD
265	Wall	Gypsum	B	Intact	Ivory	Bathroom	369	Negative	< LOD
266	Wall	Gypsum	C	Intact	Ivory	Bathroom	369	Negative	< LOD
267	Wall	Gypsum	D	Intact	Ivory	Bathroom	369	Negative	< LOD
268	Ceiling	Gypsum		Intact	Ivory	Bathroom	369	Negative	< LOD
269	Soffet	Metal	A	Intact	White	Exterior	BB-1	Negative	< LOD
270	Facia	Metal	A	Intact	White	Exterior	BB-1	Negative	< LOD
271	Gutter	Metal	A	Intact	White	Exterior	BB-1	Negative	< LOD
<b>272</b>	<b>Trim</b>	<b>Wood</b>	<b>A</b>	<b>Peeling</b>	<b>White</b>	<b>Exterior</b>	<b>BB-1</b>	<b>Positive</b>	<b>1.1</b>
273	Wall	Gypsum	A	Intact	Ivory	Sitting	Com. Bldg	Negative	< LOD
274	Wall	Gypsum	B	Intact	Ivory	Sitting	Com. Bldg	Negative	< LOD
275	Wall	Gypsum	C	Intact	Ivory	Sitting	Com. Bldg	Negative	< LOD
276	Wall	Wood	D	Intact	Red	Sitting	Com. Bldg	Negative	< LOD
277				Intact	Ivory	Sitting	Com. Bldg	Negative	< LOD
278				Intact	Ivory	Sitting	Com. Bldg	Negative	< LOD
279	Ceiling	Gypsum		Intact	White	Sitting	Com. Bldg	Negative	< LOD
280	Door Stop	Metal	C	Intact	Ivory	Sitting	Com. Bldg	Negative	< LOD
281	Beam	Wood		Intact	Varnish	Sitting	Com. Bldg	Negative	< LOD
282	Wall	Gypsum	A	Intact	Ivory	Board Rm.	Com. Bldg	Negative	< LOD
283	Wall	Gypsum	B	Intact	Ivory	Board Rm.	Com. Bldg	Negative	< LOD
284	Wall	Gypsum	C	Intact	Ivory	Board Rm.	Com. Bldg	Negative	< LOD
285	Wall	Wood	D	Intact	Red	Board Rm.	Com. Bldg	Negative	< LOD
286	Ceiling	Gypsum		Intact	Ivory	Board Rm.	Com. Bldg	Negative	< LOD
287	Beam	Wood		Intact	Ivory	Board Rm.	Com. Bldg	Negative	< LOD
288	Window Casing	Metal	C	Intact	White	Board Rm.	Com. Bldg	Negative	< LOD

LOD = LIMIT OF DETECTION



PIKE COUNTY HOUSING AUTHORITY  
PITTSFIELD

Reading #	Component	Substrate	Side	Condition	Color	Room	Unit #	Results	PbC
289	Window Sash	Metal	C	Intact	White	Board Rm.	Com. Bldg	Negative	< LOD
290	Door Stop	Metal	A	Intact	Ivory	Board Rm.	Com. Bldg	Negative	< LOD
291	Shelf	Metal	A	Intact	Ivory	Board Rm.	Com. Bldg	Negative	< LOD
292	Wall	Gypsum	A	Intact	Ivory	Hall	Com. Bldg	Negative	< LOD
293	Wall	Gypsum	B	Intact	Ivory	Hall	Com. Bldg	Negative	< LOD
294	Wall	Gypsum	C	Intact	Ivory	Hall	Com. Bldg	Negative	< LOD
295	Wall	Gypsum	D	Intact	Ivory	Hall	Com. Bldg	Negative	< LOD
296	Ceiling	Gypsum		Intact	White	Hall	Com. Bldg	Negative	< LOD
297	Jamb	Metal	A	Intact	Ivory	Hall	Com. Bldg	Negative	< LOD
298	Door	Metal	A	Intact	White	Hall	Com. Bldg	Negative	< LOD
299	Door	Wood	B	Intact	Blue	Hall	Com. Bldg	Negative	< LOD
300	Door Casing	Wood	B	Intact	Red	Hall	Com. Bldg	Negative	< LOD
301	Jamb	Wood	C	Intact	Ivory	Men R.R.	Com. Bldg	Negative	< LOD
302	Door	Wood	C	Intact	Blue	Men R.R.	Com. Bldg	Negative	< LOD
303	Wall	Gypsum	A	Intact	Ivory	Men R.R.	Com. Bldg	Negative	< LOD
304	Wall	Gypsum	B	Intact	Ivory	Men R.R.	Com. Bldg	Negative	< LOD
305	Wall	Gypsum	C	Intact	Ivory	Men R.R.	Com. Bldg	Negative	< LOD
306	Wall	Gypsum	D	Intact	Ivory	Men R.R.	Com. Bldg	Negative	< LOD
307	Ceiling	Gypsum		Intact	White	Men R.R.	Com. Bldg	Negative	< LOD
308	Stall	Metal	A	Intact	Ivory	Men R.R.	Com. Bldg	Negative	< LOD
309	Door Casing	Wood	C	Intact	Ivory	Women RR	Com. Bldg	Negative	< LOD
310	Door	Wood	C	Intact	Blue	Women RR	Com. Bldg	Negative	< LOD
311	Wall	Gypsum	A	Intact	Ivory	Women RR	Com. Bldg	Negative	< LOD
312	Wall	Gypsum	B	Intact	Ivory	Women RR	Com. Bldg	Negative	< LOD
313	Wall	Gypsum	C	Intact	Ivory	Women RR	Com. Bldg	Negative	< LOD
314	Wall	Gypsum	D	Intact	Ivory	Women RR	Com. Bldg	Negative	< LOD
315	Ceiling	Gypsum		Intact	White	Women RR	Com. Bldg	Negative	< LOD
316	Stall	Metal	A	Intact	Ivory	Women RR	Com. Bldg	Negative	< LOD
317	Jamb	Wood	A	Intact	Ivory	Laundry	Com. Bldg	Negative	< LOD
318	Door	Wood	A	Intact	Blue	Laundry	Com. Bldg	Negative	< LOD
319	Wall	Gypsum	A	Intact	Ivory	Laundry	Com. Bldg	Negative	< LOD
320	Wall	Gypsum	B	Intact	Ivory	Laundry	Com. Bldg	Negative	< LOD
321	Wall	Gypsum	C	Intact	Ivory	Laundry	Com. Bldg	Negative	< LOD
322	Wall	Gypsum	D	Intact	Ivory	Laundry	Com. Bldg	Negative	< LOD
323	Ceiling	Gypsum		Intact	Ivory	Laundry	Com. Bldg	Negative	< LOD
324	Window Casing	Metal	D	Intact	White	Laundry	Com. Bldg	Negative	< LOD
325	Window Sash	Metal	D	Intact	White	Laundry	Com. Bldg	Negative	< LOD
326	Jamb	Wood	A	Intact	Ivory	Storage	Com. Bldg	Negative	< LOD
327	Door	Wood	A	Intact	Varnish	Storage	Com. Bldg	Negative	< LOD
328	Wall	Gypsum	A	Intact	Ivory	Storage	Com. Bldg	Negative	< LOD
329	Wall	Gypsum	B	Intact	Ivory	Storage	Com. Bldg	Negative	< LOD

LOD = LIMIT OF DETECTION



PIKE COUNTY HOUSING AUTHORITY  
PITTSFIELD

Reading #	Component	Substrate	Side	Condition	Color	Room	Unit #	Results	PbC
330	Wall	Gypsum	C	Intact	Ivory	Storage	Com. Bldg	Negative	< LOD
331	Wall	Gypsum	D	Intact	Ivory	Storage	Com. Bldg	Negative	< LOD
332	Ceiling	Gypsum		Intact	Ivory	Storage	Com. Bldg	Negative	< LOD
333	Jamb	Wood	A	Intact	Red	Kitchen	Com. Bldg	Negative	< LOD
334	Door	Wood	A	Intact	Blue	Kitchen	Com. Bldg	Negative	0.23
335	Wall	Gypsum	A	Intact	Ivory	Kitchen	Com. Bldg	Negative	< LOD
336	Wall	Gypsum	B	Intact	Ivory	Kitchen	Com. Bldg	Negative	< LOD
337	Wall	Gypsum	C	Intact	Ivory	Kitchen	Com. Bldg	Negative	< LOD
338	Wall	Gypsum	D	Intact	Ivory	Kitchen	Com. Bldg	Negative	< LOD
339	Ceiling	Gypsum		Intact	Ivory	Kitchen	Com. Bldg	Negative	< LOD
340	Cabinet	Wood	C	Intact	Varnish	Kitchen	Com. Bldg	Negative	< LOD
341	Roll-up Door	Metal	B	Intact	Brown	Kitchen	Com. Bldg	Negative	< LOD
342	Vent Hood	Wood	B	Intact	Red	Kitchen	Com. Bldg	Negative	< LOD
343	Soffet	Metal	A	Intact	White	Exterior	Com. Bldg	Negative	< LOD
344	Jamb	Wood	A	Intact	White	Exterior	Com. Bldg	Negative	< LOD
345	Window Casing	Wood	A	Intact	White	Exterior	Com. Bldg	Negative	< LOD
346	Down Spout	Metal	A	Intact	White	Exterior	Com. Bldg	Negative	< LOD
347	Soffet	Metal	B	Intact	White	Exterior	Com. Bldg	Negative	< LOD
348	Soffet	Metal	B	Intact	White	Exterior	Com. Bldg	Negative	< LOD
349	Trim	Wood	B	Intact	Blue	Exterior	Com. Bldg	Negative	< LOD
350	Calibrate								1
352	Calibrate								1

LOD = LIMIT OF DETECTION

# **SECTION 4**

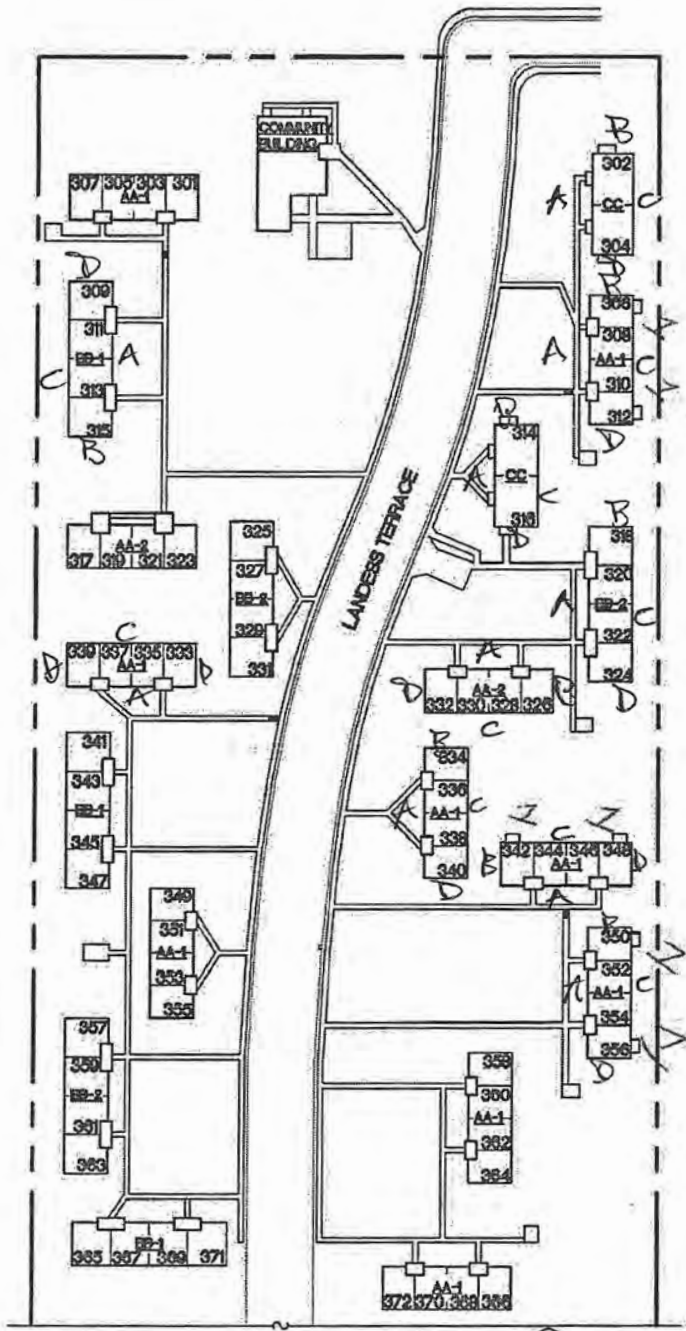

**KEY SITE PLAN**  
 NOT TO SCALE L-71-9/PITTSFIELD



9675

Project No.: 1059  
 Date: JAN 2012  
 Drawn: MSM  
 Checked: MBD

Project Title:  
 KEY SITE PLANS

Projects:  
 IL-71-1, IL-71-2, IL-71-3, IL-71-4, IL-71-5, IL-71-6,  
 IL-71-9, IL-71-10, IL-71-13, IL-71-14 & IL-71-15

For The:  
 PIKE COUNTY HOUSING AUTHORITY

**EGGEMEYER ASSOCIATES ARCHITECTS**  
 Westtown Centre  
 P.O. Box 1447  
 Carbondale, IL 62903  
 IDPR 184-000255  
 T 618.549.3361  
 F 618.549.3363  
 eggemeyer-architects.com

Sheet:  
**C-10**  
 of 15

# **SECTION 5**



Illinois Department of  
**PUBLIC  
HEALTH**

**LEAD RISK  
ASSESSOR LICENSE**

LEAD ID ISSUED EXPIRES  
001417 1/31/2013 1/31/2014

Darrin Hinds  
2975 Stanton St  
Springfield, IL 62703



ILLINOIS LEAD PROGRAM  
Environmental Health

Alteration of this license shall result in legal action  
RISK ASSESSOR CERTIFICATE EXPIRES  
8/23/2013

This license issued under authority of the State  
of Illinois -Department of Public Health

This license is valid only when accompanied by  
a valid training course certificate

If found return to 525 W. Jefferson St Springfield, IL 62761

# HINDS ENVIRONMENTAL, INC.

Certifies that *Darrin Hinds*

has completed the requisite training for lead accreditation under USEPA entitled:  
**LEAD RISK ASSESSOR REFRESHER  
TRAINING COURSE**

in accordance with 40 CFR Part 745  
and successfully passed the exam with a score of 70% or above.

Course Date(s): August 26, 2010

Exam Date: August 26, 2010

Expiration Date: August 26, 2013

Certificate Number: RAR/0044

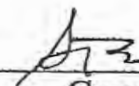

Course Instructor, Steve Honn

Accredited by the Illinois Department of Public Health  
2975 Stanton Street Springfield, Illinois 62703-4345 (217) 585-8970



**NITON**<sup>®</sup> corporation

# *Certificate of Achievement*

*This is to certify that*

*Darrin Hinds*

*Hinds Environmental Inc.*

*has successfully completed the Manufacturer's Training Course  
for the **NITON XL** Spectrum Analyzer*

*The one-day course covered radiation safety and monitoring,  
L x-ray measurement technology, and  
machine maintenance of the **XL** Lead-in-Paint Detector*

V960904-19

Certificate Number

09/4/96-- Springfield, IL

Course Date & Site

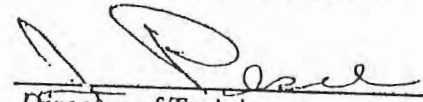
  
Director of Training

  
President & CEO - NITON

RE: Annual Medical Information

TO WHOM IT MAY CONCERN:

All Hinds Environmental, Inc. employees who perform project management, air monitoring or building inspection activities have annual medical examinations in accordance with OSHA.

According to the Health Insurance Portability and Accountability Act (HIPAA), medical information is to be kept confidential. This letter serves as documentation that the medical examinations on our employees are current and the complete exam reports are kept in confidential files at Hinds Environmental, Inc., 2975 Stanton Street, Springfield, IL 62703 (217-585-8970).



## RESPIRATOR TRAINING AND FIT TEST ACKNOWLEDGEMENT

Hinds Environmental, Inc.'s respirator protection program includes but is not limited to the following components.

I acknowledge that I have received information on use of respiratory protection as contained in the EPA/NIOSH "Guide to Respiratory Protection for the Asbestos Abatement Industry" and OSHA respiratory protection requirements of 1910.134.

I acknowledge that I have participated in hands-on training in the use, limitations, and restrictions of respiratory protection.

I acknowledge that I have received information on the proper cleaning and maintenance of respiratory equipment.

---

---

NAME: Darrin Hinds DATE: 5-2-13  
HALF FACE RESPIRATORY MANUFACTURER/TYPE: North  
HALF FACE MODEL/APPROVAL #: 5500 Series SIZE: Medium  
PAPR RESPIRATORY MANUFACTURER/TYPE: MSA  
PAPR MODEL/APPROVAL #: Ultra Elite SIZE: Medium  
TYPE OF TEST CONDUCTED: QUALITATIVE NEGATIVE PRESSURE  
TESTING AGENT USED: IRRITANT SMOKE  
TEST CONDUCTED BY: Steven Horn  
SIGNATURE OF PERSON BEING FITTED: [Signature]  
SIGNATURE OF PERSON CONDUCTING TEST: Steven Horn

OFFICIAL USE ONLY - SECURITY RELATED INFORMATION

STATE OF ILLINOIS  
ILLINOIS EMERGENCY MANAGEMENT AGENCY  
DIVISION OF NUCLEAR SAFETY  
1035 OUTER PARK DRIVE  
SPRINGFIELD, ILLINOIS 62704  
(217) 785-9947

RADIOACTIVE MATERIAL LICENSE

Pursuant to the Illinois Radiation Protection Act and the rules and regulations in 32 Illinois Administrative Code promulgated thereunder, and in reliance on statements and representations heretofore made by the licensee, a license is hereby issued authorizing the licensee to receive, acquire, own, possess and transfer radioactive material(s) listed herein; and to use such radioactive material(s) for the purpose(s) and at the place(s) designated below. This license is subject to all applicable rules, regulations and orders of the Agency now or hereafter in effect and to any conditions specified in the license.

LICENSEE  
Hinds Environmental, Inc.  
2975 Stanton Street  
Springfield, IL 62703

LICENSE NUMBER  
IL-01992-01

EXPIRATION DATE  
September 30, 2016

AMENDMENT NUMBER  
7

Attention: Darrin Hinds  
Radiation Safety Officer

In accordance with letter with attachment dated January 28, 2011, License Number IL-01992-01 is amended in its entirety. Previous amendments are void.

ITEM	RADIONUCLIDE	CHEMICAL and/or PHYSICAL FORM	MAXIMUM ACTIVITY* PER SOURCE	MAXIMUM POSSESSION LIMIT
A.	Cd-109	Sealed Sources - QSA Global, Inc. [formerly AEA Technology (Amersham)] Model CUC.D1 or CUC.P1; Isotope Products Laboratories Model XFB-3.	50 mCi	250 mCi

AUTHORIZED USE:

- A. For use in Thermo Niton Analyzers, LLC XLi Series and XLp Series x-ray fluorescence analyzers for measuring elemental content in various materials.

CONDITIONS

- 1. Radioactive material shall be used at the licensee's facilities located at 2975 Stanton Street, Springfield, Illinois and at temporary jobsites of the licensee in the State of Illinois in accordance with statements, representations and procedures listed in other conditions of this license.

\*  $\mu$ Ci-microcurie; mCi-millicurie; Ci-Curie; MBq-Megabecquerel; GBq-Gigabecquerel; TBq-Terabecquerel; g-gram;  $\mu$ g-microgram; kg-kilogram

APPROVED BY: <i>Mary E. Burkhart</i> Mary E. Burkhart, Supervisor of Materials Licensing IL 475-0059	DATE January 31, 2012	PAGE of PAGES 1 3
---	--------------------------	----------------------

OFFICIAL USE ONLY - SECURITY RELATED INFORMATION

STATE OF ILLINOIS  
IEMA DIVISION OF NUCLEAR SAFETY  
RADIOACTIVE MATERIAL LICENSE

<u>LICENSEE</u>	<u>LICENSE NUMBER</u>	<u>AMENDMENT NUMBER</u>	<u>EXPIRATION DATE</u>
Hinds Environmental, Inc.	IL-01992-01	7	September 30, 2016

2. Radioactive material shall be used by, or under the supervision and in the physical presence of, Darrin Hinds, Steve Homm, or individuals who have successfully completed the manufacturer's training course or an equivalent Agency approved training course. The licensee shall maintain training records of all designated users.
3. The Radiation Safety Officer for this license is Darrin Hinds.
4.
  - A. Each sealed source possessed under this license shall be tested for leakage and/or contamination as specified in 32 Ill. Adm. Code 340.410. Tests for leakage and/or contamination shall be performed by persons specifically licensed to provide such services.
  - B. This license does not authorize analysis of leak test samples. However, the licensee is authorized to collect leak test samples for analysis by persons specifically authorized by the Agency, an Agreement State, or the U.S. Nuclear Regulatory Commission to perform such services.
5. Maintenance, repair and initial radiation monitoring of devices containing radioactive material shall be performed only by persons specifically authorized by the Agency, an Agreement State, or the Nuclear Regulatory Commission to perform such services.
6.
  - A. The source holder shall be locked in the "off" or closed position when the device is not in use.
  - B. Sealed sources shall not be opened or removed from their source holders by the licensee.
7. When performing tests at temporary job sites, the authorized user shall not leave the device unattended. Upon completion of tests, the device shall be locked in the licensee's vehicle or a secure building to prevent unauthorized use, loss, or theft.
8. At any time the licensee is engaged in making measurements by authority of this license at a temporary job site, the licensee shall have a current copy of each of the following documents available at the temporary job site for inspection by the Agency:
  - A. The license, including all active amendments;
  - B. The manufacturer's instruction manual for the sealed sources and devices at the temporary job site;
  - C. The licensee's emergency procedures; and
  - D. The results of the latest test for leakage and/or contamination performed on the sealed source.

\*  $\mu$ Ci-microcurie; mCi-millicurie; Ci-Curie; MBq-Megabecquerel; GBq-Gigabecquerel; TBq-Terabecquerel; g-gram;  $\mu$ g-microgram; kg-kilogram

APPROVED BY:

DATE

PAGE of PAGES

Mary E. Burkhardt, Supervisor of Materials Licensing  
IL 473-0059

January 31, 2012

2 3

**OFFICIAL USE ONLY - SECURITY RELATED INFORMATION**

STATE OF ILLINOIS  
IEMA DIVISION OF NUCLEAR SAFETY  
RADIOACTIVE MATERIAL LICENSE

<u>LICENSEE</u>	<u>LICENSE NUMBER</u>	<u>AMENDMENT NUMBER</u>	<u>EXPIRATION DATE</u>
Hinds Environmental, Inc.	IL-01992-01	7	September 30, 2016

9. Except as specifically provided otherwise by the license, the licensee shall possess and use radioactive material described in all schedules of this license in accordance with statements, representations and procedures contained in, referenced in, or enclosed with the documents listed below. The regulations contained in 32 Ill. Adm. Code: Chapter II, Subchapters b and d shall govern unless the statements, representations and procedures in the licensee's application and correspondence are more restrictive than the regulations. The most recent statements, representations and procedures listed below shall govern if they conflict with previously submitted documents.
- A. Applications dated August 14, 2001 and January 28, 2011.

MEB:NIA:ljc

\*  $\mu$ Ci-microcurie; mCi-millicurie; Ci-Curie; MBq-Megabecquerel; GBq-Gigabecquerel; TBq-Terabecquerel; g-gram;  $\mu$ g-microgram; kg-kilogram

APPROVED BY:	DATE	PAGE of PAGES
--------------	------	---------------

Mary E. Burkhart, Supervisor of Materials Licensing  
IL 473-0059

January 31, 2012

3 3